



102 West Division Street  
Suite 100  
Syracuse, NY 13204  
Phone # 315.476-1022

50 Elk Street  
Suite 400  
Buffalo, NY 14210

270 River Street  
Suite 202B  
Troy, NY 12180

---

January 16, 2025

**Willis V. Carrier Recreation Center**  
**Town of DeWitt**  
Project No. TOD PH3

## **Addendum No. 2**

---

**All Bidders shall take note of the following clarifications, changes, deletions, and additions to the Bidding and Contract Documents for the above-mentioned Project. The following instructions take precedence over anything contrarily shown on the Drawings or described in the Specifications. Acknowledge receipt of this Addendum by including its number and date in the appropriate place on the Bid Form. Failure to do so may be considered an informality and may disqualify the bid.**

This Addendum consists of (5) five pages, not including attachments.

**I. Clarifications:**

1. RFI: What type of wiring (power and communication) will be required for each camera?  
Answer: One CAT 6 wire (in Conduit) will be required from the PressBox Building to each camera.
  
2. RFI: Will the cameras be fed from their respective scoreboard(s)?  
Answer: No.
  
3. RFI: Drawing P2 at Toilet Room Building there is a fixture shown outside of building, However on P6-2, drawing shows PF-H in same location.  
Answer: Drawing P2 has incorrect fixture tag. The fixture shown is PF-H as scheduled on P1.
  
4. RFI: Who is responsible to supply and connect piping to grease interceptor?  
Answer: Plumbing contractor is responsible for providing the grease interceptor(including setting grease interceptor in place) and grease piping. Plumbing contractor is responsible for excavation, trenching and backfilling to 5'-0" outside of Pavilion building.
  
5. RFI: Who is responsible for excavation and backfill for grease interceptor?  
Answer: Site contractor is responsible for excavation, trenching and backfilling to grease interceptor.
  
6. RFI: Who provides the Drywell detail on Drawing P6?  
Answer: Drywell is provided by the Plumbing contractor. Refer to Addendum #2 drawing AD2-P1 for Drywell detail.
  
7. RFI: What is the basis of design for the grease interceptor?  
Answer: Schier GB-1000 with sampling port or approved equal. Refer to attached Addendum #2 drawing AD2-P2 for schedule revision.

8. RFI: Is Service weight cast iron piping required for the new Sanitary Sewer main shown from toilet room all the way up to Pavillion?  
Answer: Provide Solid-Wall PVC Piping ASTM D 2665, Schedule 40 in lieu of Service weight cast-iron piping from toilet room to Pavilion.
9. RFI: Drawing P2 detail 7 indicates L.P. tank provided by owners vendor. Drawing P5 detail 12 indicates tying L.P. line into MUA-1. Who is responsible for the excavation and the L.P. piping run from tank to building?  
Answer: Plumbing contractor is responsible for excavation, trenching, backfilling from 5'-0" of building and installation of LP piping from tank to building.
10. RFI: Page P-7 detail 15 indicates a 4" domestic water riser into the building. Drawings only seem to indicate a 2" domestic service. Which is the correct size?  
Answer: Provide 2" CW piping service
11. RFI: Drawing P-4 mentions camering of existing sewer from municipal and throughout the building. Drawing also seems to indicate all new sanitary and grease waste piping.  
Answer: Delete general note on drawing P-4 to provide camering of existing sewer from municipal and throughout the building. Remove existing piping and provide new piping.
12. RFI: Is there any fire alarm systems required in this project  
Answer: No new fire alarm systems are included in this project
13. RFI: Is there a specifications for the HUDL camera system?  
Answer: See specifications provided in Addenda #2
14. RFI: Is the electrical contractor to provide power for temporary heating and ventilation, as well as to provide the heating units and power?  
Answer: Electrical contractor will provide all temporary power. Refer to Specifications 011100-Summary of Work for more information.
15. RFI: Is there a detail for warning track?  
Answer: See drawing AD2-L3, and also see bid specification section 323003 for warning track material
16. RFI: Is there an item for stone mulch?  
Answer: Provide No.3 round river cobbles, installed depth of 6".
17. RFI: E.7 pole counts, Pole fixture schedules shows pole ID with fixture quantities showing 1,3,1. On the site lighting plan it only shows 1 of the fixtures, so does these poles have 3 separate heads/lamps and/or several mounting heights per pole?  
Answer: Plan view identifies assembly locations. Quantity of fixtures per pole is identified on the Summary Schedule. There are fixtures mounted at different heights on the poles.
18. RFI: Sheet E.7- Keynote 1 Backbox typical of 4, is this pole mounted? Who provides and what type of pole? It does not show circuitry.  
Answer: Camera back boxes will be mounted on the backstop fencing. Refer to Addendum drawing AD2-E1 for additional information.
19. RFI: Sheet E.7- Are the receptacles shown on a fence? What structure are they affixed to and are they any special WP/Outside boxes needed? How is the raceways, underground/surface?

Answer: Refer to Drawing Keyed Notes 2 and 3. Circuiting shall be underground with final surface mounted connections at device.

20. RFI: Sheet E.7- Is the scoreboard underground to panel? Are pathways existing? What is the height to Jbox?

Answer: Yes, it is underground to panel, pathways are not existings. And the height to JBox is approximately 8' AFG.

21. RFI: Drawing 11/A10 - W2 windows in press box have no call out to paint, are they to be painted?

Answer: Lintels to be painted.

22. RFI: Drawing 5/A15 calls out painting existing wood paneling w/PT4 which is an interior ceiling paint - assume exterior paint in color white is required?

Answer: Provide PT-5(Exterior Paint), color to be chosen by Owner.

23. RFI: Pavilion Concessions Drawing A12 - calls out for wood beam and columns prep for new stain Demo note M.2 (only in area PC01) - is this going to be done by GC or painting contractor requirement? What about exposed beams in other areas of pavilion building?

Answer: Work to be included in the GC bid (there is no separate prime painting contract). The work should assigned to all exposed wood beams.

24. RFI: A13 Keyed Note 1 - who is responsible for preparing surface for painting of existing brick surfaces?

Answer: Work to be included in the GC bid (there is no separate prime painting contract).

25. RFI: A19 finish schedule calls out ceiling finish PT4, then key note calls out paint wood deck PT1 ( along with room PC02 which has ACT1 ceiling) - which is requirement for finish?

Answer: **DELETE** Note 1 from the Finish Schedule for PC-02. **REFER** to Key Note #1 in the Finish Schedule and **CHANGE** "**PT-1**" to "**PT-4**".

26. RFI: Drawing P6 - Note E references painting of all piping as well as spec 099123 referencing Painting Fire Suppression, Plumbing, HVAC, Electrical, Communication, and Electronic Safety and Security Work exposed. Will this be the responsibility of each respective GC or painting contractor?

Answer: MEP trades shall be responsible for painting their respective piping and equipment, as required (there is no separate prime painting contract).

## II. In the Project Manual:

a. In Specifications Section 323004-Portable Aluminum Bleachers:  
Article 2.1, **DELETE** subparagraph D in its entirety.

And

**REPLACE** with "D. Standard of Quality shall be portable aluminum bleachers as manufactured by National Recreation Systems, Inc., 888-568-9064, E&D Specialties (800)-525-8515, or Architect approve equal. Provide the following model(s) wheel kit to move the section in one operation:

Model TR-0324PRF          3 rows x 24' length    48 net seats: Provide ten (10) sets"

b. In Specifications Section 323005-Elevated Aluminum Bleachers:

Contractor to provide elevated aluminum bleachers with ADA ramps per code ICC-300-2023 on both ends of elevated bleachers. A stair and ramp are required at each end of elevated bleachers. Provide shop drawings as specified.

- c. In Specifications Section 323005-Elevated Aluminum Bleachers:  
Article 2.10, **DELETE** sentence “Guardrail shall consist of 9 gauge, 2" mesh aluminized chain link fabric, tension bars, brace bands, combo rail end caps and wire ties.”  
And  
**REPLACE** with “Guardrail shall consist of 9 gauge, 2" mesh BLACK vinyl chain link fabric, tension bars, brace bands, combo rail end caps and wire ties.”
- d. In Specifications Section 323006-Non-Elevated Aluminum Bleachers:  
Article 2.10, **DELETE** sentence “Approximately 256 seat fixed non-elevated angle frame bleachers include, but are not limited to, the following:”  
  
**REPLACE** with “Approximately 120 seat fixed non-elevated angle frame bleachers include, but are not limited to, the following:”
- e. In Specifications Section 323006-Non-Elevated Aluminum Bleachers:  
Article 2.1 Subparagraph A, **DELETE** “6 units” and **REPLACE** with “8 units.”
- f. In Specifications Section 323002-Site Elements:  
**DELETE** Article 2.7 in its entirety, **REPLACE** with:  
“Shall be a freestanding shade structure utilizing two main support posts and a T-cantilevered fabric shade structure canopy, 10’-0” high x 12” deep x 24’-0” wide. Steel frame with powder coated finish (color as selected by the Owner). Hardware is 316 stainless steel. Shade fabric shall be Heavy duty, 62.9 mils (1.6 mm) thick professional grade shade fabric for tensioned structures and other shade applications. Made from UV stabilized HDPE monofilament and tape yarns. (color as selected by the Owner). Rapid Release shall be standard. Product shall be SkyWays T-cantilevers by Landscape Structures, Inc., and distributed by Parkitects or Architect approved equal. Contact: Karen O’Connor; 607-327-0169.
- g. In Specifications Section 012300-Alternates  
**DELETE** Paragraph S-5 “Scoreboards: The Bidder shall state the amount to be **ADDED** to the Base Bid to furnish and install the Scoreboards as shown on the plans and as specified. Note: If this Alternate is NOT accepted by the Owner, furnishing and installing the scoreboards footings and steel columns shall remain in the Base Bid.”  
  
**INSERT:**  
Paragraph S-5 “Scoreboards: The Bidder shall state the amount to be **ADDED** to the Base Bid to furnish and install the Scoreboards, Video Displays, and Delay of Game Clocks and other items specified in Specifications 323007, as shown on the plans and as specified. Note: If this Alternate is NOT accepted by the Owner, furnishing and installing the scoreboards footings and steel columns shall remain in the Base Bid.”
- h. In Specifications Section 323002-Site Elements:  
**INSERT:**  
2.14 COMMUNICATION BOXES:  
A. Shall be 18"W x 30"L x 14"H constructed of 3/16" aluminum, for synthetic turf installation. Cover is made of 1/8" aluminum (plywood unacceptable) and includes flexible gasket seals to prevent infill migration. Cover shall be recessed to accept synthetic infill turf. Shall have two (2) 10-1/8" diameter hand holes with circular lids; lids to have “turn and lock” feature.

- B. Basis of design and standard of quality shall be model CBIT1830 ComBox® as manufactured by Sportsfield Specialties, Inc., 888-975-3343, or Architect approved equal.
- i. In Specifications Section 221316 – Sanitary Waste And Vent Piping:  
REFER TO Article 3.2.C.1 and **ADD** “and Solid Wall PVC ASTM D 2665 Schedule 40” as being acceptable.

**III. In the Drawings:**

- a. On sheet L2 Site Plan Notes:
  - 1. **DELETE** note 11
- b. On sheet P1:
  - 1. **REVISE** Grease Interceptor Schedule as indicated on AD2-P2. Plumbing Contractor is responsible for furnishing and installing the grease interceptor and piping. Plumbing Contractor is responsible for excavation, trenching and backfilling to 5’-0” outside of Building. Site Contractor is responsible for excavation, trenching and backfilling to grease interceptor.
- c. On sheet P1:
  - 1. **REVISE** Packaged Terminal Air Conditioner Schedule to what is indicated on AD2-P5.
- d. On sheet P2:
  - 1. **CHANGE** fixture tag PF-F to PF-H.
- e. On sheet P2:
  - 1. **REVISE** Pavillion Sanitary and Waste piping configuration to what is indicated on AD2-P3 and AD2-P4.
- f. On sheet P6:
  - 1. **ADD** Drywell Detail AD2-P1. Drywell is to be furnished and installed by Plumbing Contractor.
- g. On sheet P7:
  - 1. **REVISE** Exterior Pipe Trench Detail 4 to what is indicated on AD2-P6.
- h. On sheet P7:
  - 1. **DETAIL 15** – CHANGE Domestic Water Service Size from 4” to 2”.
- i. On sheet E7:
  - 1. **ADD** sports lighting assembly circuit routing from existing manholes to each pole location in coordination with Drawing E8. **ADD** Backstop Live Feed Camera System Schematic Diagram and Video Scoreboard System LV Interconnect Diagram as indicated on AD2-E1.

**IV. Attachments:**

- a. Addendum drawings AD2-L1, AD2-L2, AD2-L3, AD2-L4 (1 of 4), AD2-L4 (2 of 4), AD2-L4 (3 of 4), AD2-L4 (4 of 4), AD2-L5; AD2-E1, AD2-P1, AD2-P2, AD2-P3, AD2-P4, AD2-P5, AD2-P6

END OF ADDENDUM No.2

Willis V. Carrier Recreation Center - Phase 3

Town of DeWitt  
1035 Kinne Street  
East Syracuse, NY 13057

Project Number:	TOD-PH3
Drawn By:	
Checked By:	
Scale:	AS SHOWN

This drawing and all information contained herein, remains the property of APPEL OSBORNE LANDSCAPE ARCHITECTURE. All rights are reserved and this drawing may not be reproduced in whole or in part without the express written consent of APPEL OSBORNE LANDSCAPE ARCHITECTURE.

Date: 1-16-2025

AD2-L1

Sheet Number:

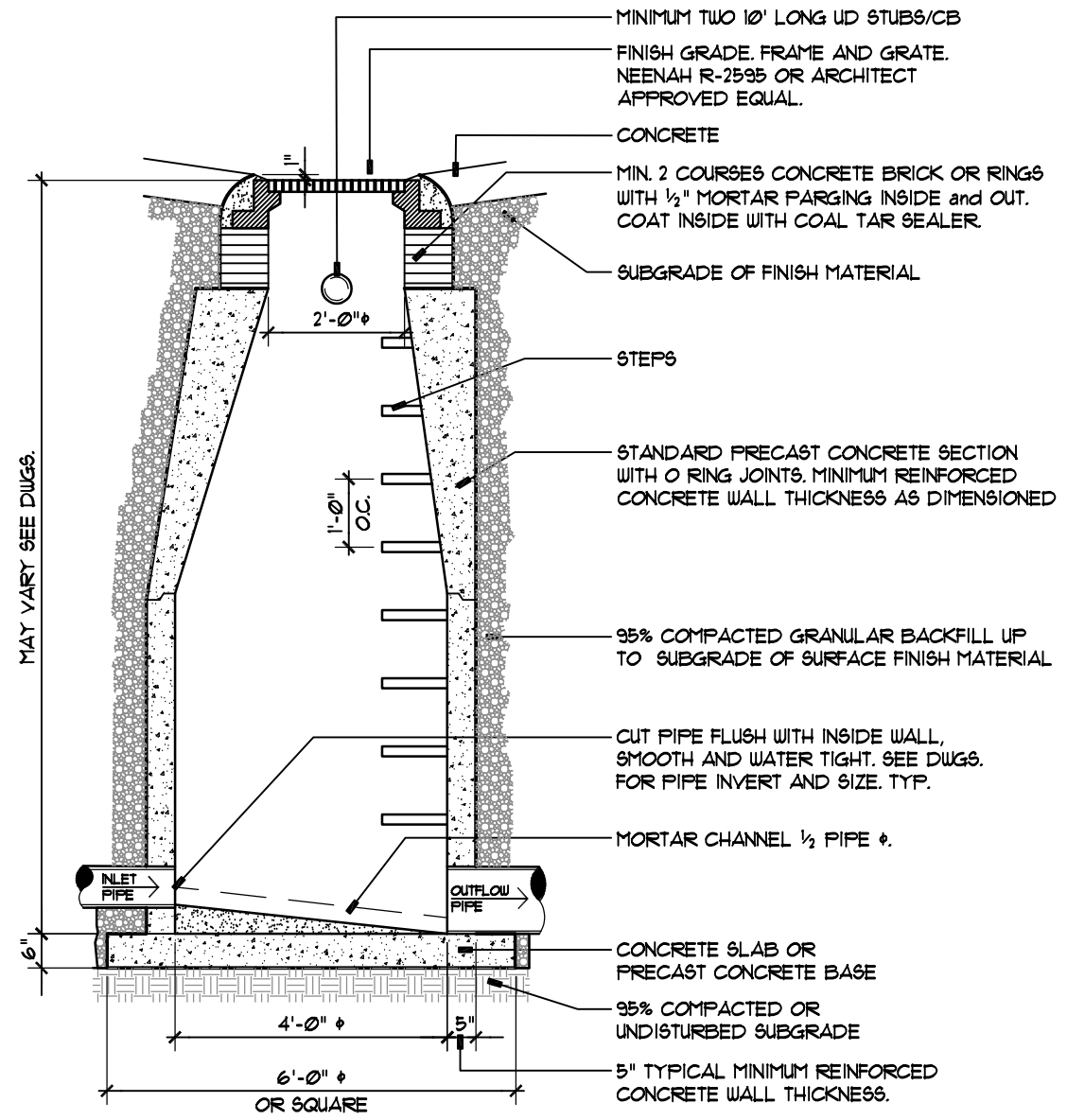

**1 STORM MANHOLE = MH**  
AD2 SECTION - NOT TO SCALE 3340-203A  
© APPEL OSBORNE LANDSCAPE ARCHITECTURE

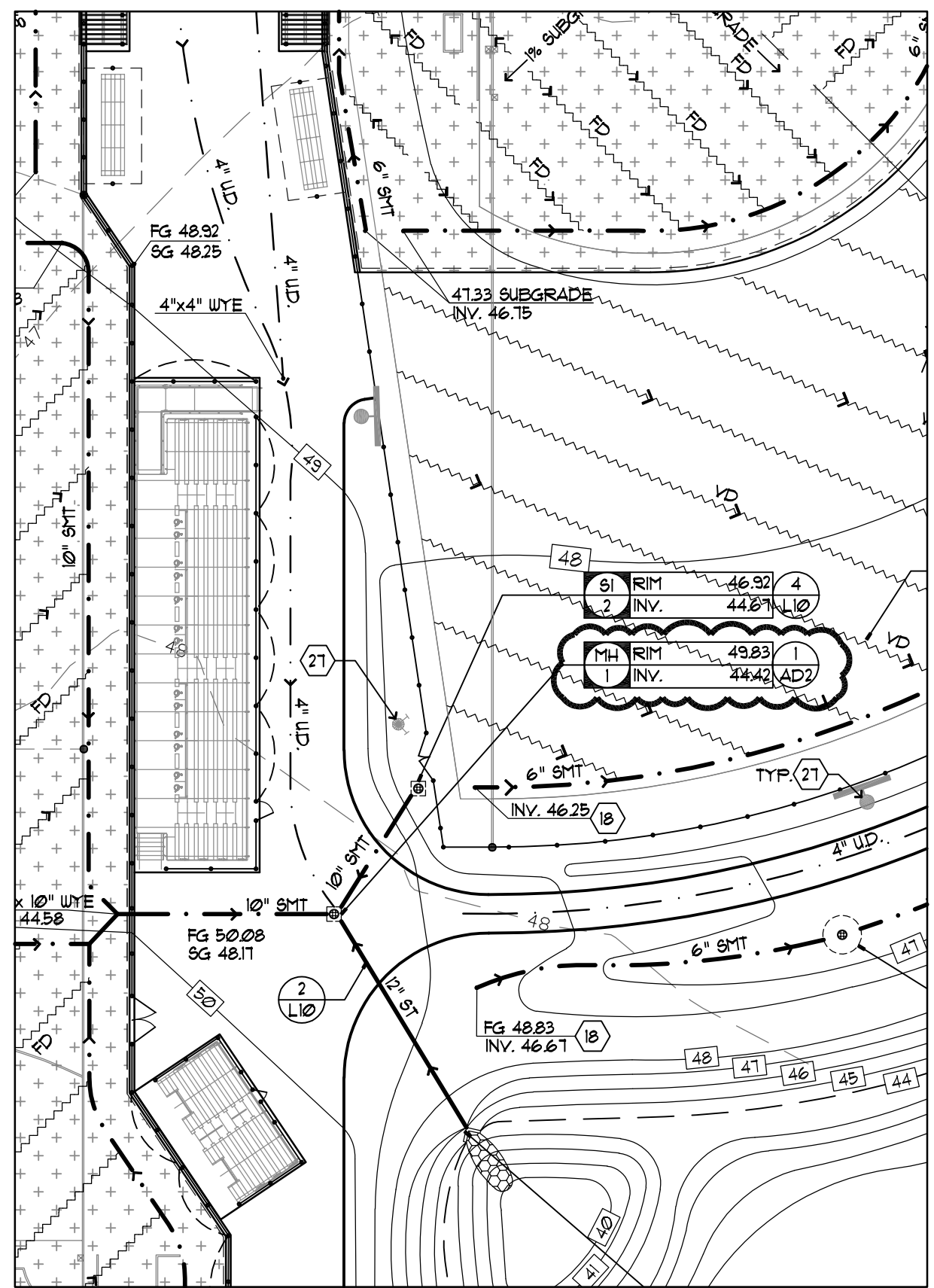

SITE UTILITIES

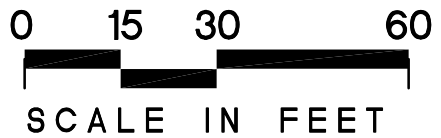

Project Number:	TOD-PH3
Drawn By:	
Checked By:	
Scale:	AS SHOWN

This drawing and all information contained herein, remains the property of APPEL OSBORNE LANDSCAPE ARCHITECTURE. All rights are reserved and this drawing may not be reproduced in whole or in part without the express written consent of APPEL OSBORNE LANDSCAPE ARCHITECTURE.

Date: 1-16-2025

AD2-L2

Sheet Number: 1 OF 1

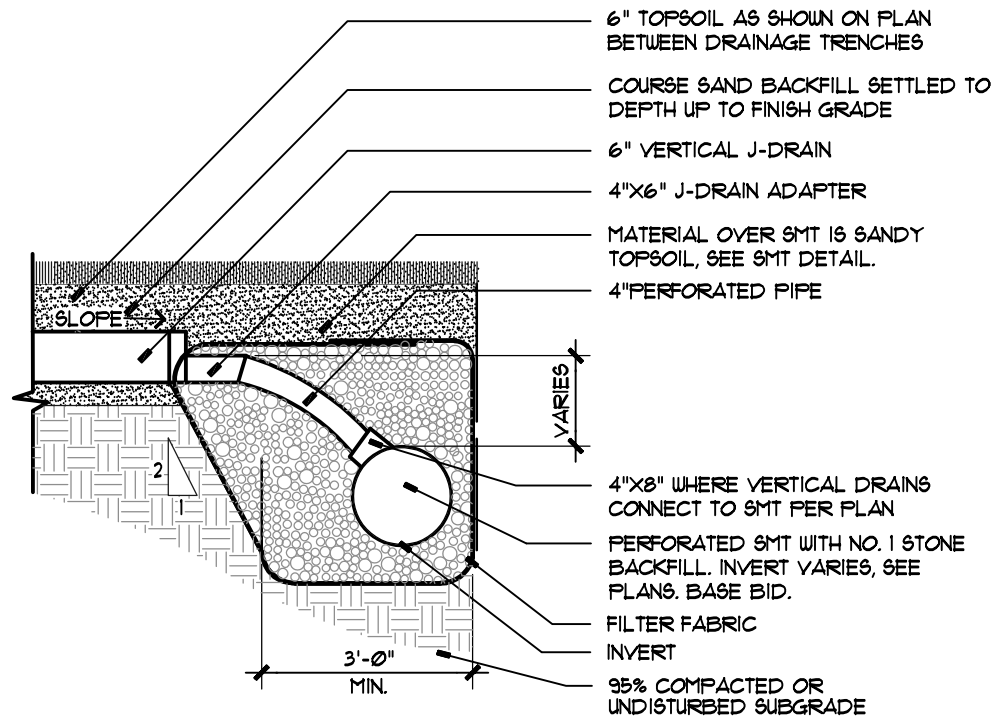

**3 VERTICAL DRAIN TO SMT CONNECTION**  
AD2 SECTION • NOT TO SCALE 3230-406  
© APPEL OSBORNE LANDSCAPE ARCHITECTURE

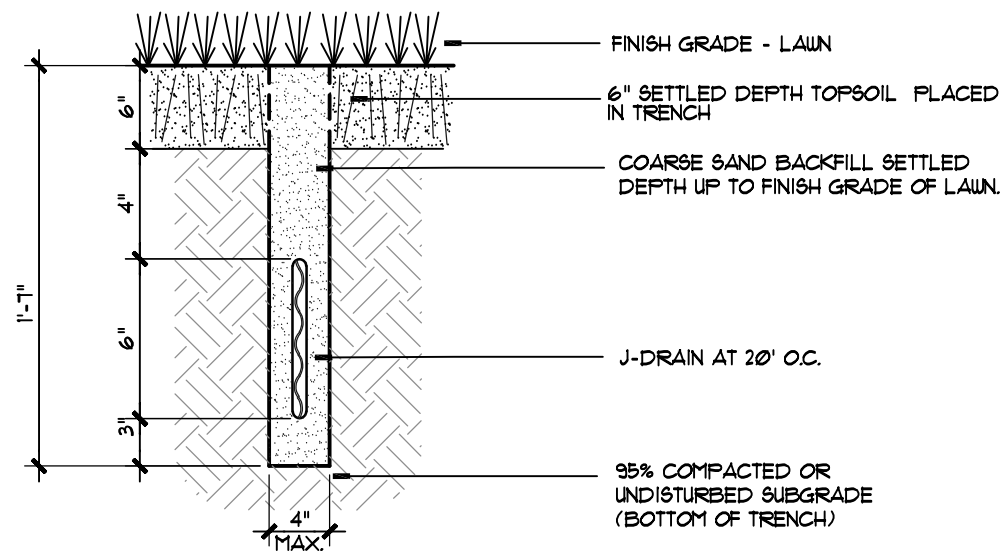

**2 VERTICAL DRAIN TRENCH - V-DRAIN**  
AD2 SECTION • NOT TO SCALE 3230-405  
© APPEL OSBORNE LANDSCAPE ARCHITECTURE

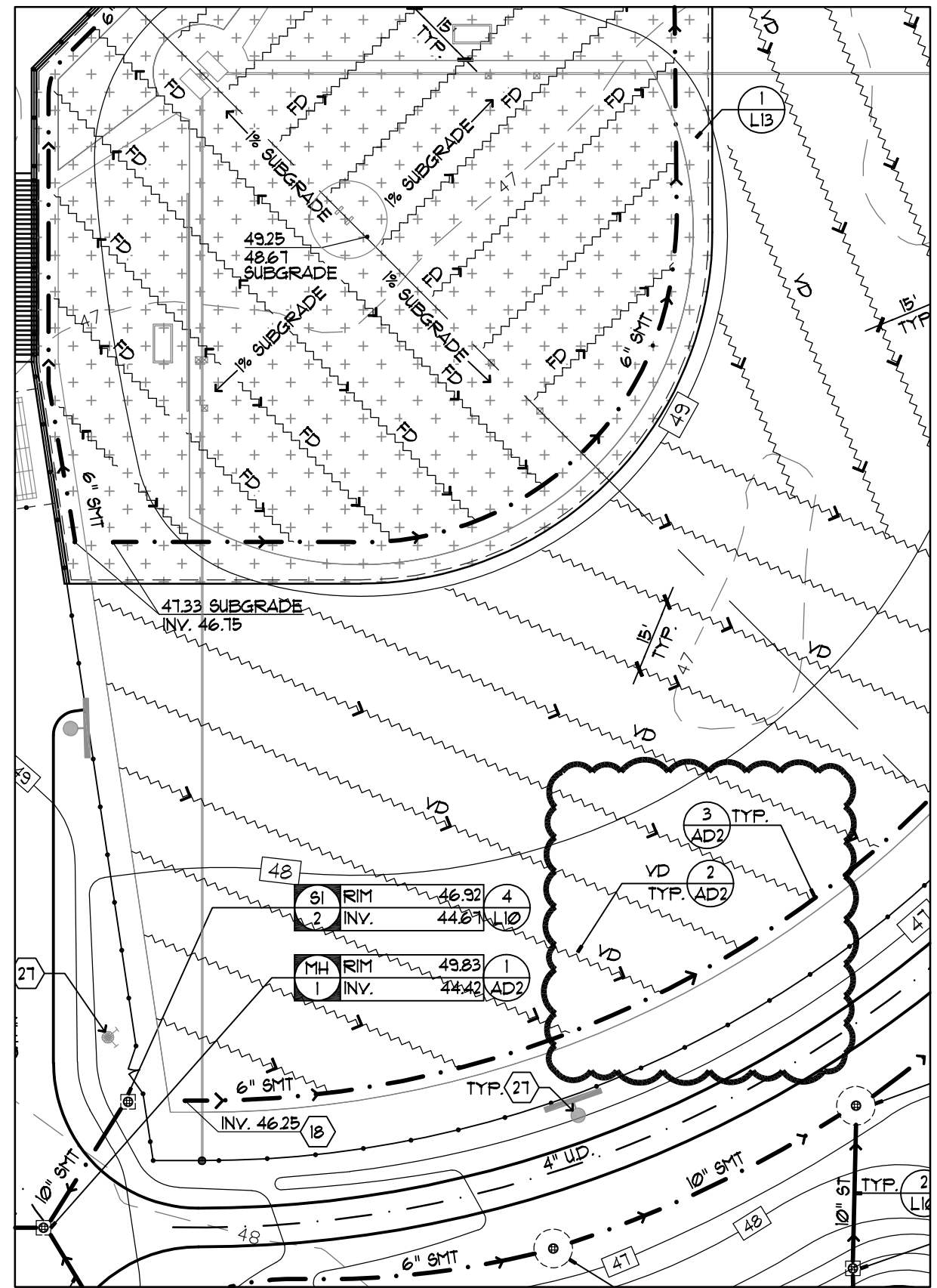

SITE UTILITIES

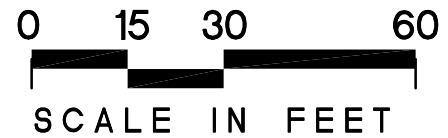

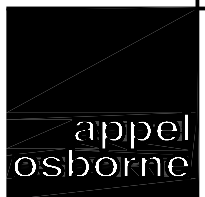

landscape  
architecture

102 West Division St. Suite 100  
Syracuse, New York 13204-1434  
Telephone 315.476.1022

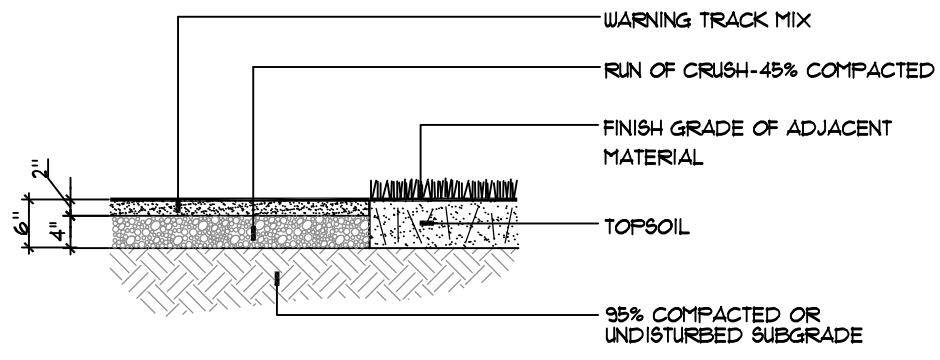

**4** **WARNING TRACK**  
AD2 SECTION • NOT TO SCALE 3230-407  
© APPEL OSBORNE LANDSCAPE ARCHITECTURE

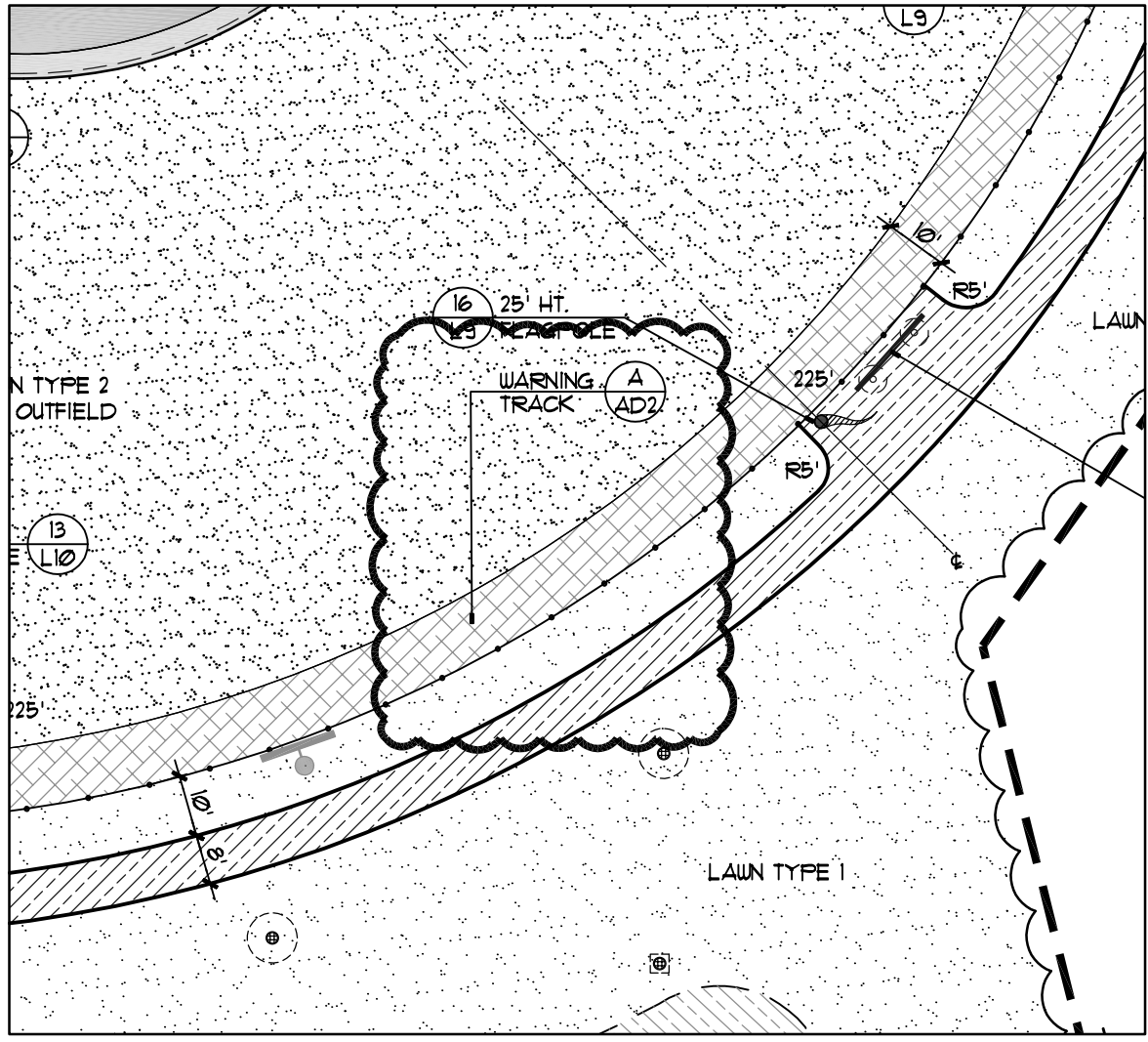

**Willis V. Carrier Recreation Center - Phase 3**  
**Town of DeWitt**  
1035 Kinne Street  
East Syracuse, NY 13057

Project Number:	TOD-PH3
Drawn By:	
Checked By:	
Scale:	AS SHOWN

This drawing and all information contained herein, remains the property of APPEL OSBORNE LANDSCAPE ARCHITECTURE. All rights are expressly reserved and this drawing may not be reproduced in whole or in part without the express written consent of APPEL OSBORNE LANDSCAPE ARCHITECTURE.

Date: 1-16-2025

**AD2-L3**  
Sheet Number: 1 OF 1

**SITE LAYOUT**

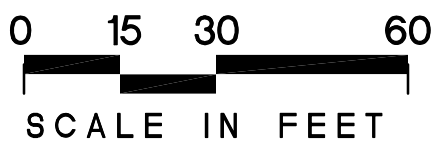



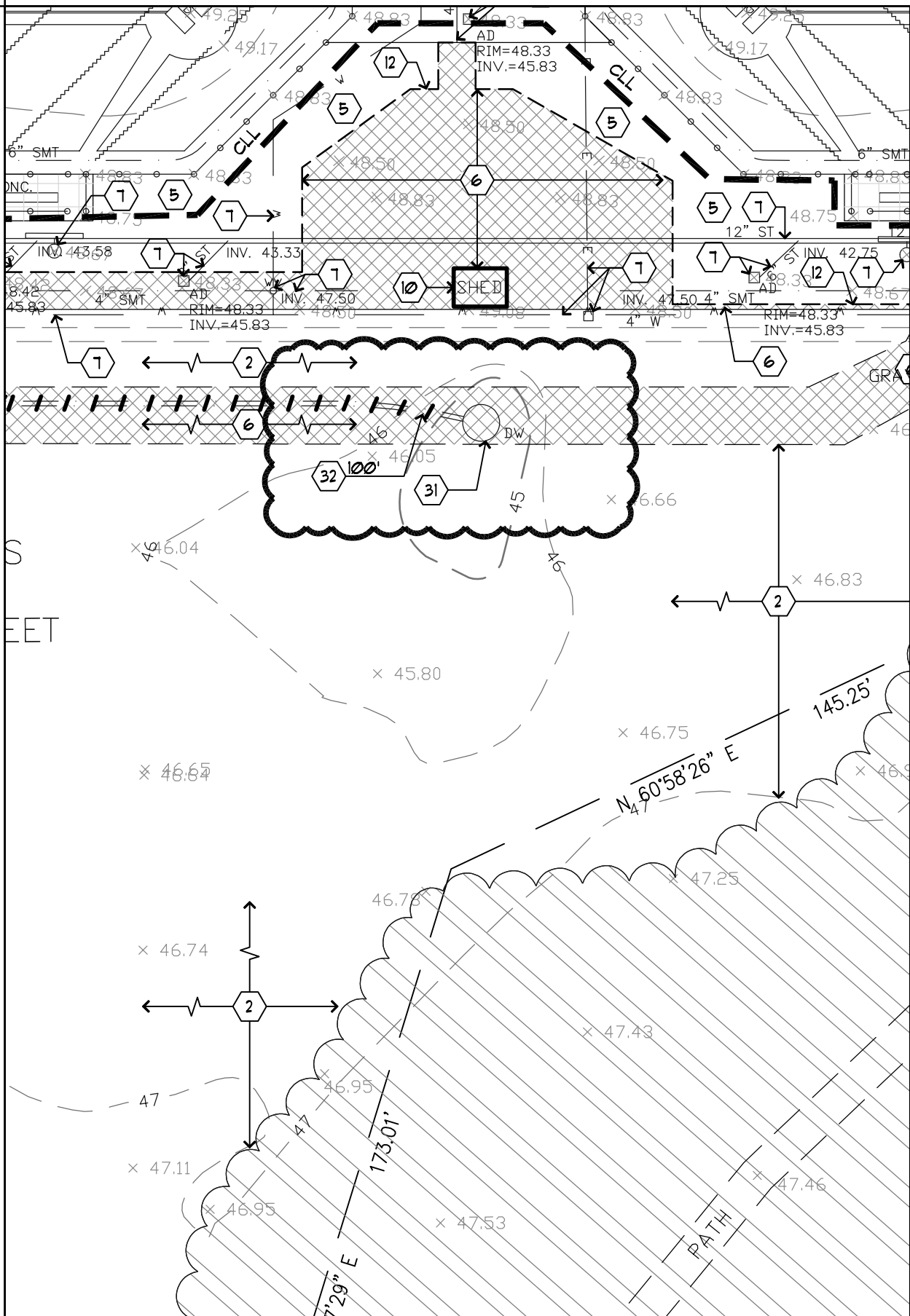

**Willis V. Carrier Recreation Center - Phase 3**  
**Town of DeWitt**  
1035 Kinne Street  
East Syracuse, NY 13057

Project Number:	TOD-PH3
Drawn By:	
Checked By:	
Scale:	AS SHOWN

This drawing and all information contained herein, remains the property of APPEL OSBORNE LANDSCAPE ARCHITECTURE. All rights are expressly reserved and this drawing may not be reproduced in whole or in part without the express written consent of APPEL OSBORNE LANDSCAPE ARCHITECTURE.

Date: 1-16-2025

**SITE PREP**

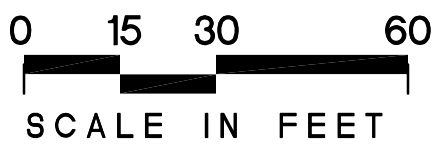

AD2-L5  
Sheet Number: 1 OF 1

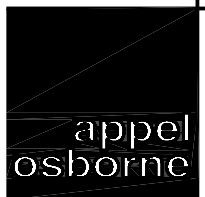

landscape  
architecture

102 West Division St. Suite 100  
Syracuse, New York 13204-1434  
Telephone 315.476.1022

**Willis V. Carrier Recreation Center - Phase 3**

**Town of DeWitt**  
1035 Kinne Street  
East Syracuse, NY 13057

Project Number:	TOD-PH3
Drawn By:	
Checked By:	
Scale:	AS SHOWN

This drawing and all information contained herein, remains the property of APPEL OSBORNE LANDSCAPE ARCHITECTURE. All rights are expressly reserved and this drawing may not be reproduced in whole or in part without the express written consent of APPEL OSBORNE LANDSCAPE ARCHITECTURE.

Date: 1-16-2025

AD2-L4  
Sheet Number: 1 OF 4

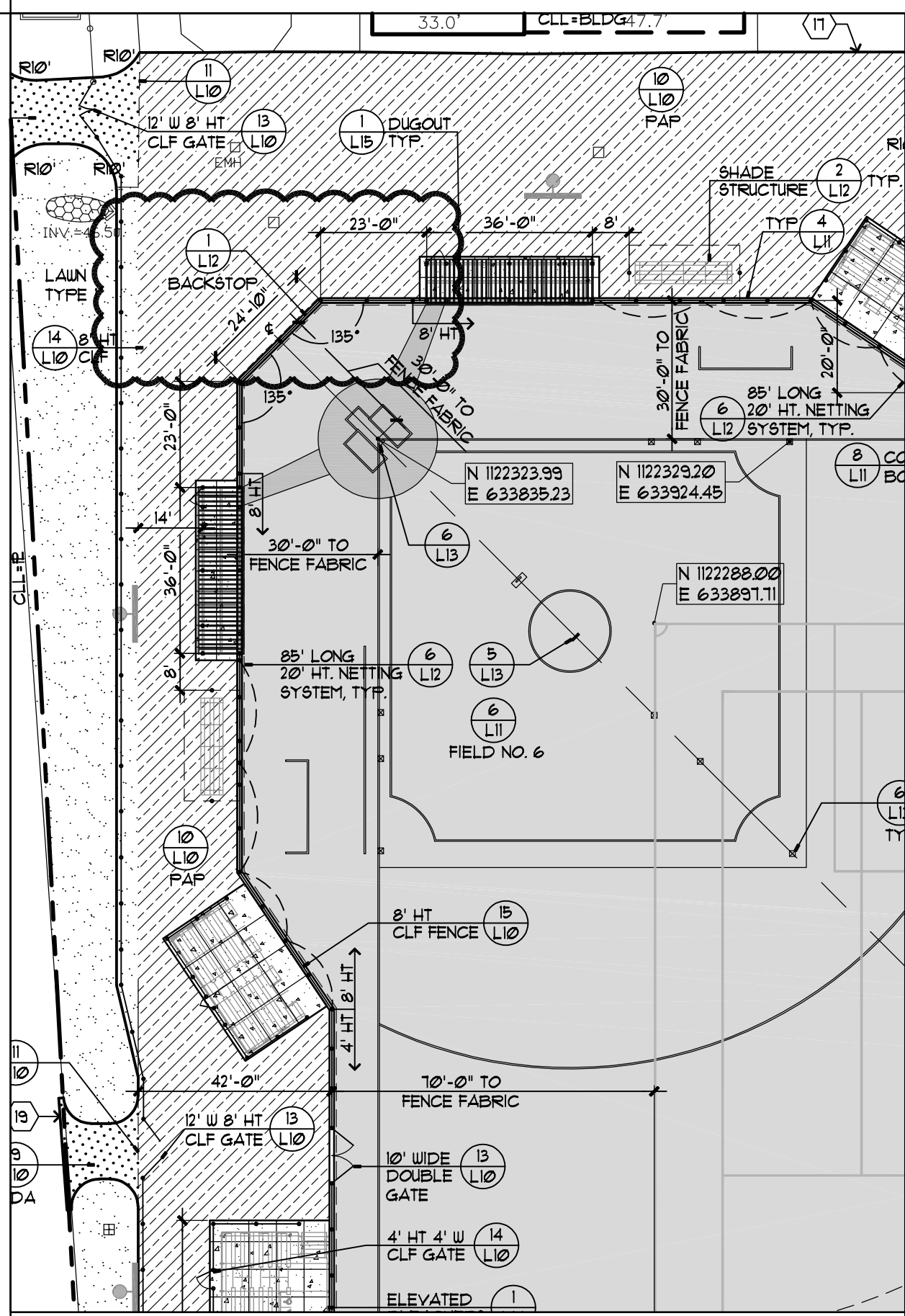

**SITE LAYOUT**

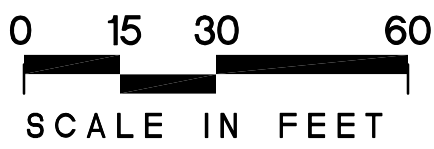

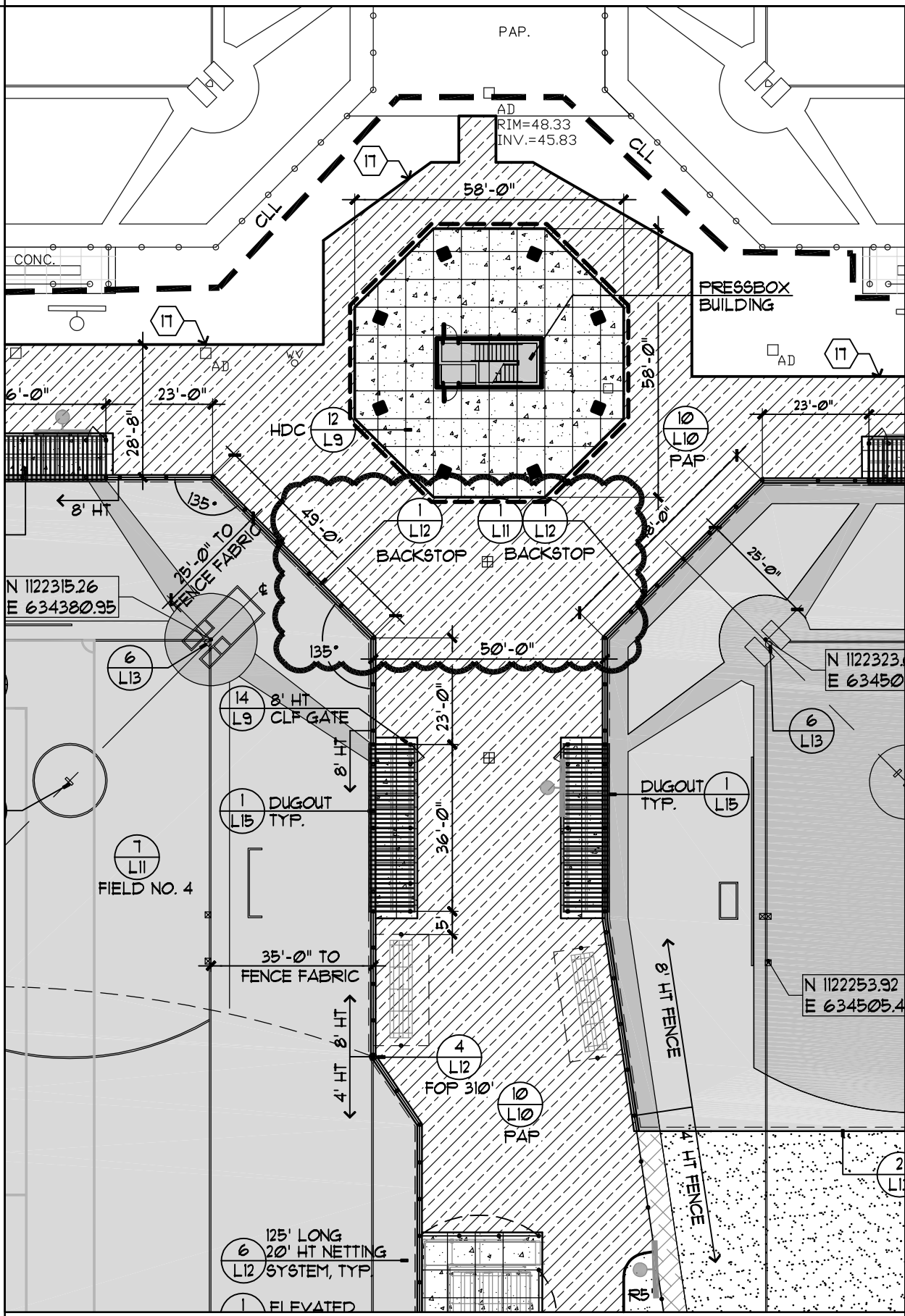

**Willis V. Carrier Recreation Center - Phase 3**  
**Town of DeWitt**  
1035 Kinne Street  
East Syracuse, NY 13057

Project Number:	TOD-PH3
Drawn By:	
Checked By:	
Scale:	AS SHOWN

This drawing and all information contained herein, remains the property of APPEL OSBORNE LANDSCAPE ARCHITECTURE. All rights are expressly reserved and this drawing may not be reproduced in whole or in part without the express written consent of APPEL OSBORNE LANDSCAPE ARCHITECTURE.

Date: 1-16-2025

**SITE LAYOUT**

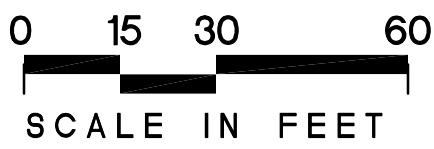

**AD2-L4**

Sheet Number: 2 OF 4



Willis V. Carrier Recreation Center - Phase 3

Town of DeWitt  
1035 Kinne Street  
East Syracuse, NY 13057

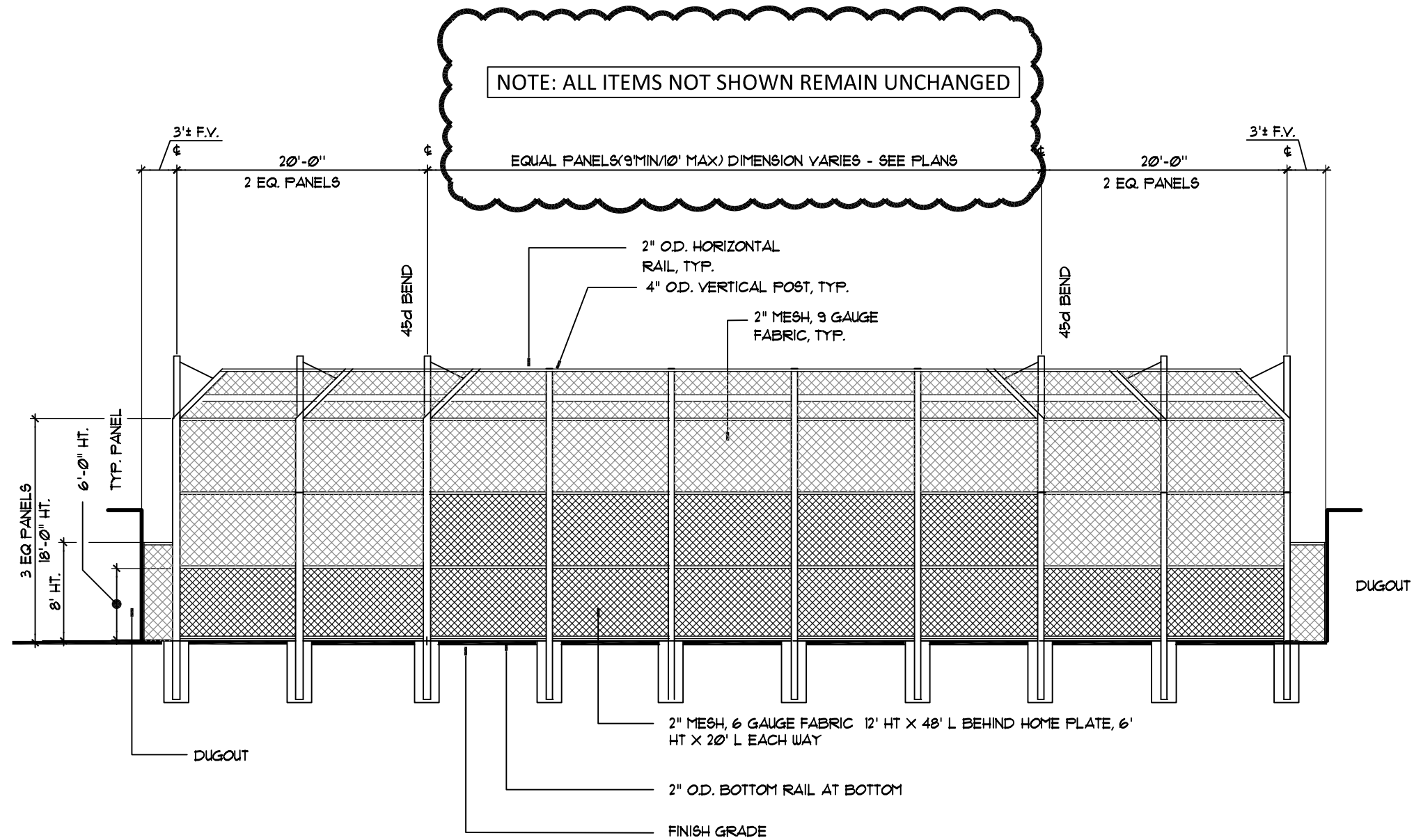

ELEVATION

NOTES: 1. CHAIN LINK MESH SHALL HAVE KNUCKLED SELVAGES TOP AND BOTTOM

**BACKSTOP WITH CANOPY - 24' HEIGHT**  
SECTION • NOT TO SCALE M275-004B

© APPEL OSBORNE LANDSCAPE ARCHITECTURE

Project Number:	TCD-PH3
Drawn By:	
Checked By:	
Scale:	AS SHOWN

This drawing and all information contained herein, remains the property of APPEL OSBORNE LANDSCAPE ARCHITECTURE. All rights are hereby reserved and this drawing may not be reproduced in whole or in part without the express written consent of APPEL OSBORNE LANDSCAPE ARCHITECTURE.

Date: 1-16-2025

AD2-L4

Sheet Number: 4 OF 4



Argus Engineering, PLLC  
208 Ross Road  
Syracuse, NY 13211  
315.476.6863

Willis V. Carrier Recreation Center - Phase 3

Town of DeWitt  
1035 Kinne Street  
East Syracuse, NY 13057

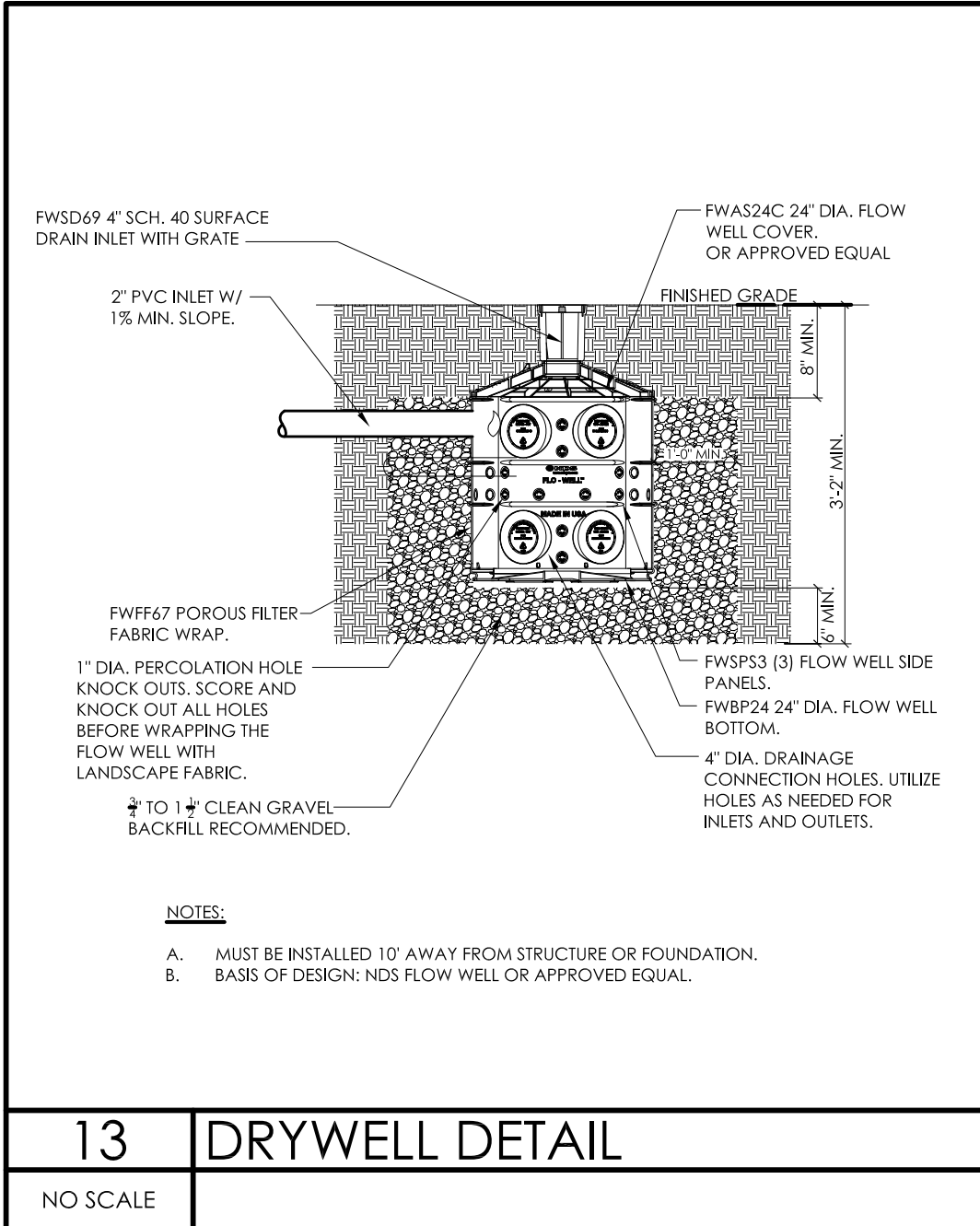

Project Number:	TOD-PH3
Drawn By:	AJK
Checked By:	JWD
Scale:	AS SHOWN

This drawing and all information contained herein, remains the property of APPEL OSBORNE LANDSCAPE ARCHITECTURE. All rights are expressly reserved and this drawing may not be reproduced in whole or in part without the express written consent of APPEL OSBORNE LANDSCAPE ARCHITECTURE.

Date: 01-16-25

**AD2-P1**

Sheet Number: 1 OF 1

# GREASE INTERCEPTOR

UNIT TAG	SERVICE	PIPE SIZE (IN)	HOLDING CAPACITY GALLONS	BASIS OF DESIGN	NOTES
GI-A	BUILDING	4"	1000	SCHIER MODEL #GB-1000	A

**NOTES:**

- A. PROVIDE H20 RATED COVERS AND SAMPLING PORT.
- B. INSTALL PER MANUFACTURER'S INSTRUCTIONS AND RECOMMENDATIONS.



**landscape  
architecture**

102 West Dimeson St. Suite 100  
Syracuse, New York 13204 - 1434  
Telephone 315.476.1022



Argus Engineering, PLLC  
200 East Hill  
Syracuse NY 13211  
315.476.0861

**Willis V. Carrier Recreation Center - Phase 3**

**Town of DeWitt**  
1035 Kinne Street  
East Syracuse, NY 13057

Project Number:	TOD-PH3
Drawn By:	AJK
Checked By:	JWD
Scale:	AS SHOWN

This drawing and all information contained herein, remains the property of APPEL OSBORNE LANDSCAPE ARCHITECTURE. All rights are expressly reserved and this drawing may not be reproduced in whole or in part without the express written consent of APPEL OSBORNE LANDSCAPE ARCHITECTURE.

Date:	01-16-25
REFERENCE DWG:	P1
<b>AD2-P2</b>	
Sheet Number:	1 OF 1



Argus Engineering, PLLC  
100 West Division Street  
Syracuse, NY 13203  
315.476.1022

Willis V. Carrier Recreation Center - Phase 3

Town of DeWitt  
1035 Kinne Street  
East Syracuse, NY 13057

Project Number:	TCDPH3
Drawn By:	AJK
Checked By:	JWD
Scale:	AS SHOWN

This drawing and all information contained herein, remains the property of APPEL OSBORNE LANDSCAPE ARCHITECTURE. All rights are expressly reserved and this drawing may not be reproduced in whole or in part without the express written consent of APPEL OSBORNE LANDSCAPE ARCHITECTURE.

Date: 01-16-25

REFERENCE DWG: P2

**AD2-P3**

Sheet Number: 1 OF 1

## KEYED NOTES:

- 8 GREASE INTERCEPTOR SAMPLING PORT.
- 10 CAP AND ABANDON UNUSED SANITARY PIPING AFFECTED BY INSTALLATIONS.

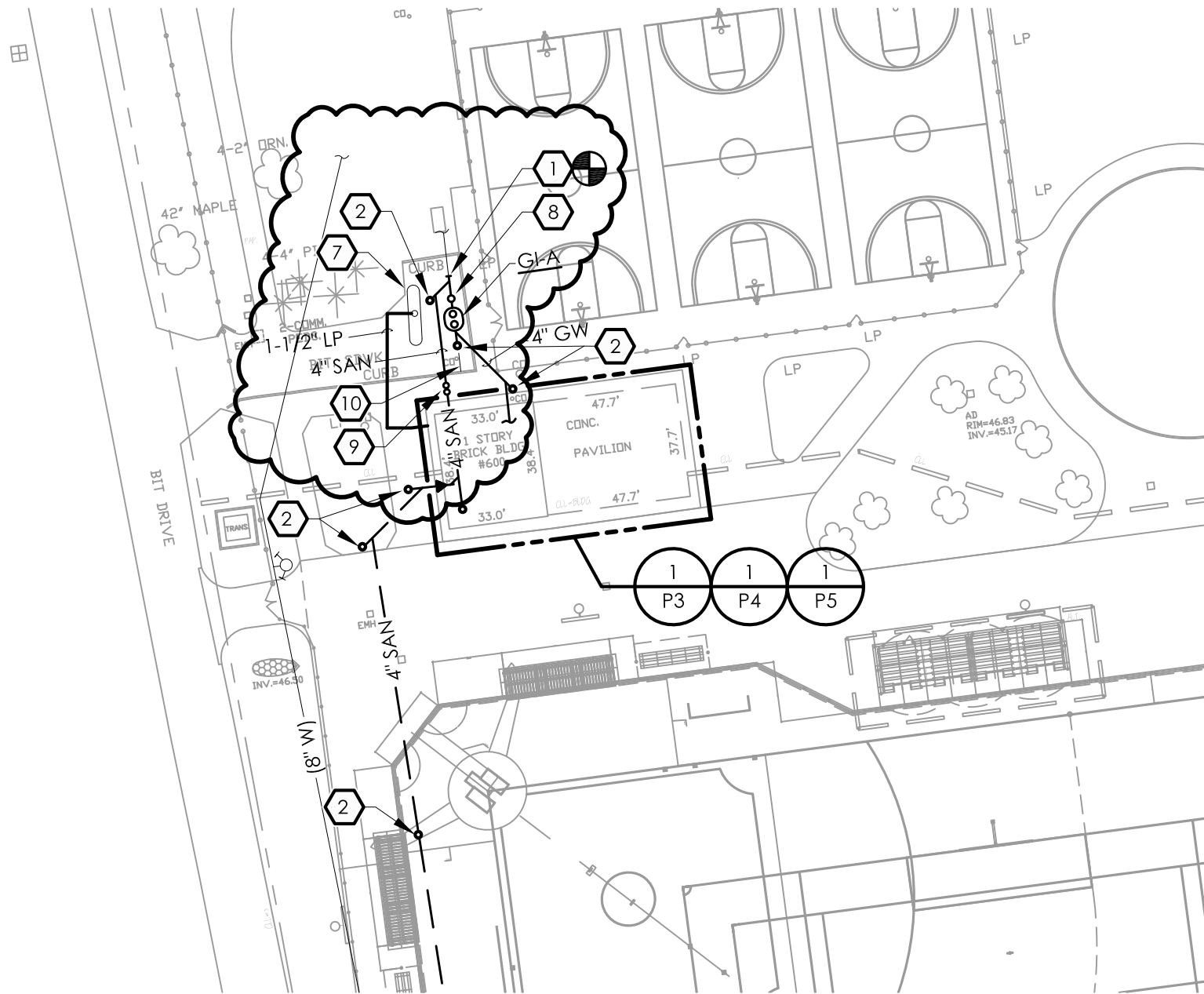



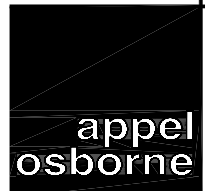
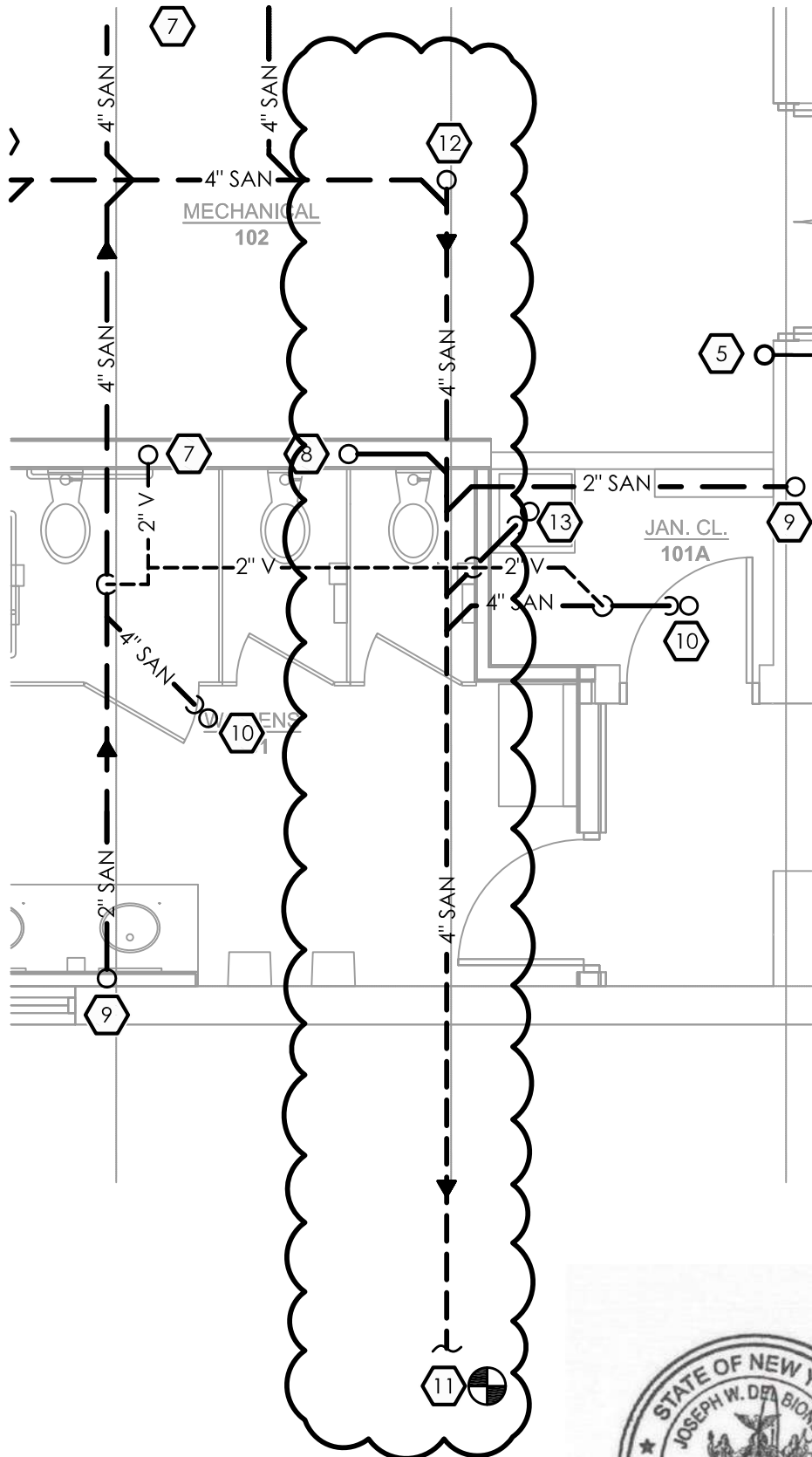

appel  
osborne  
landscape  
architecture

102 West Division St. Suite 100  
Syracuse, New York 13204-1434  
Telephone 315.476.1022



ARGUS  
Engineering, PLLC  
200 East Road  
Syracuse NY 13211  
315.476.0661

**Willis V. Carrier Recreation Center - Phase 3**  
**Town of DeWitt**  
 1035 Kinne Street  
 East Syracuse, NY 13057

Project Number:	TOD-PH3
Drawn By:	AJK
Checked By:	JWD
Scale:	AS SHOWN

This drawing and all information contained herein, remains the property of APPEL OSBORNE LANDSCAPE ARCHITECTURE. All rights are expressly reserved and this drawing may not be reproduced in whole or in part without the express written consent of APPEL OSBORNE LANDSCAPE ARCHITECTURE.

Date: 01-16-25  
REFERENCE DWG: P4

**AD2-P4**

Sheet Number: 1 OF 1



Argus Engineering, PLLC  
700 Ross Road  
Syracuse, NY 13215  
315.475.8862

## PACKAGED TERMINAL AIR CONDITIONER SCHEDULE

UNIT TAG	SERVICE	LOCATION	AIRFLOW (CFM)	MINIMUM OA (CFM)	EER	ELECTRIC HEATING PERFORMANCE DATA			COOLING PERFORMANCE DATA				MOTOR DATA				BASIS OF DESIGN	NOTES
						TOTAL (MBH)	KW	AMPS	EDB (°F)	EWB (°F)	TOTAL (MBH)	SENSIBLE (MBH)	HP	VOLTS	PHASE (Hz)	FREQ		
PTAC-A	PRESS BOX	SEE PLANS	300	70	9.8	-	3.5	15	80	67	9	6	-	208	1	60	AMANA MODEL# PBE093E35AX	A, B, C, D, E, F, G, H

**NOTES:**

- A. COOLING PERFORMANCE BASED UPON 95°F OUTDOOR AMBIENT AIR TEMPERATURE.
- B. FURNISH UNIT WITH FILTER AND INSULATED WALL SLEEVE.
- C. VERIFY WALL SLEEVE THICKNESS PRIOR TO ORDERING EQUIPMENT.
- D. AIRFLOW INDICATED IS FOR FAN ON HIGH SPEED.
- E. FURNISH UNIT WITH LOW AMBIENT CONTROL AND COMPRESSOR LOCKOUT BELOW 40°F.
- F. FURNISH UNIT WITH FREEZE PROTECTION TO OVERRIDE THERMOSTAT AND ENABLE ELECTRIC HEAT IF ROOM TEMPERATURE FALLS BELOW 60°F.
- G. UNIT SHALL BE COMPLETELY INTERNALLY WIRED FOR A SINGLE POINT CONNECTION, AND FURNISHED WITH ELECTRICAL DISCONNECT.
- H. PROVIDE ARCHITECTURAL OUTDOOR GRILLE.

Willis V. Carrier Recreation Center - Phase 3

Town of DeWitt  
1035 Kinne Street  
East Syracuse, NY 13057



Project Number:	TOD-PFG
Drawn By:	AJK
Checked By:	JWD
Scale:	AS SHOWN

This drawing and all information contained herein, remains the property of APPEL OSBORNE LANDSCAPE ARCHITECTURE. All rights are expressly reserved and this drawing may not be reproduced in whole or in part without the express written consent of APPEL OSBORNE LANDSCAPE ARCHITECTURE.

Date: 01-16-25

REFERENCE DWG: P1

**AD2-P5**

Sheet Number: 1 OF 1



Argus Engineering, PLLC  
202 East Main  
Syracuse NY 13211  
315.476.6861

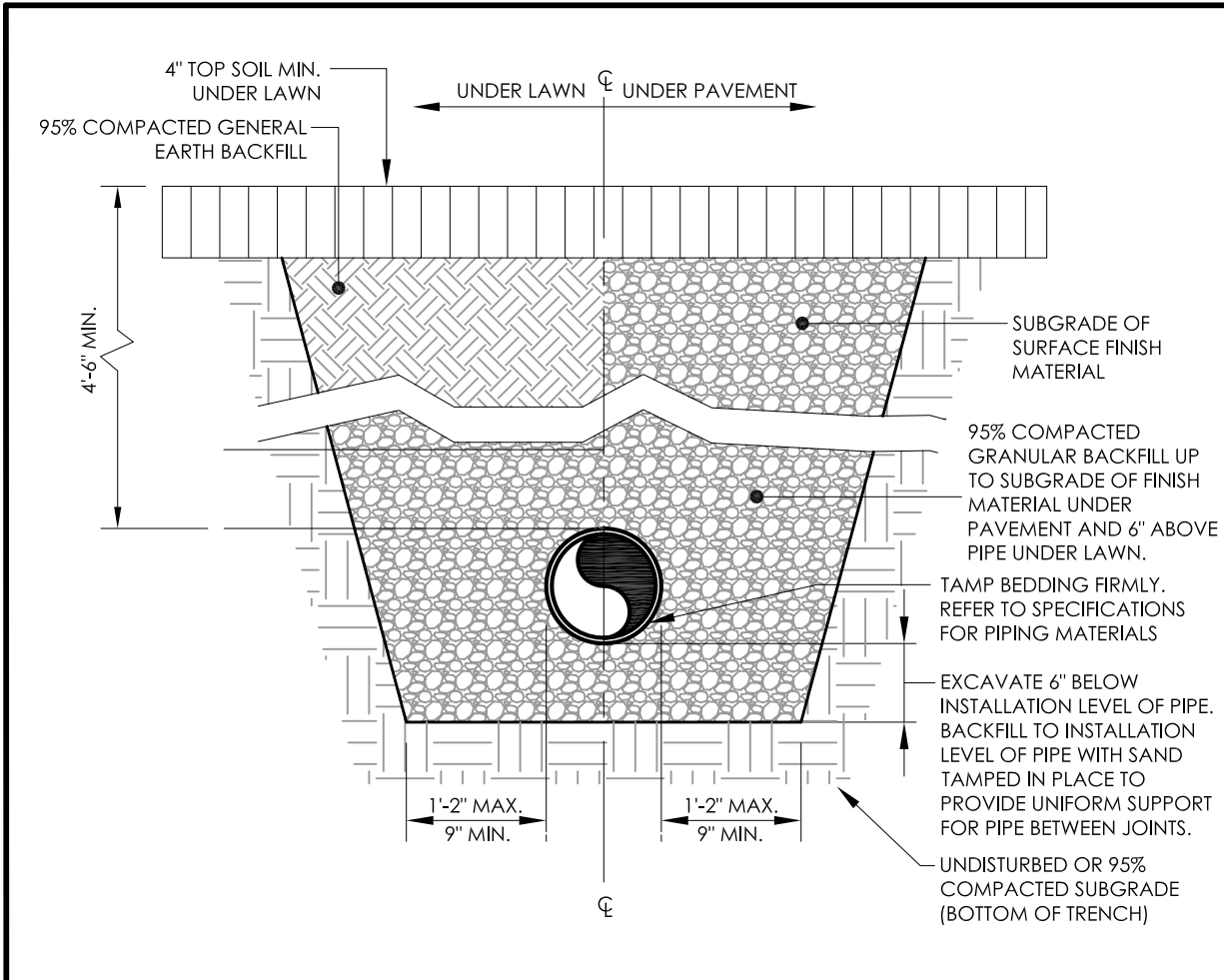

4	PIPE TRENCH DETAIL - EXTERIOR SANITARY
NO SCALE	DRAINAGE PIPING

Willis V. Carrier Recreation Center - Phase 3

Town of DeWitt  
1035 Kinne Street  
East Syracuse, NY 13057



Project Number:	TOD-PH3
Drawn By:	AJK
Checked By:	JWD
Scale:	AS SHOWN

This drawing and all information contained herein remains the property of APPEL OSBORNE LANDSCAPE ARCHITECTURE. All rights are expressly reserved and this drawing may not be reproduced in whole or in part without the express written consent of APPEL OSBORNE LANDSCAPE ARCHITECTURE.

Date: 01-16-25

REFERENCE DWG: P7

**AD2-P6**

Sheet Number: 1 OF 1