

## GENERAL NOTES

1. TOPOGRAPHIC AND BOUNDARY SURVEY PREPARED BY CT MALE ASSOCIATES, SYRACUSE, DATED OCTOBER 5, 2022.  
  
OWNER AND ARCHITECT DO NOT CONFIRM THE COMPLETENESS OR ACCURACY OF SUCH INFORMATION. CONTRACTOR IS RESPONSIBLE FOR THOROUGH EXAMINATION AND VERIFICATION OF ALL EXISTING SURFACE AND SUBSURFACE CONDITIONS AFFECTING THE NATURE, SCOPE, COMPLEXITY AND COST OF THE CONTRACT WORK. ADDITIONAL INFORMATION ON EXISTING CONDITIONS HAS BEEN ADDED TO THE DRAWINGS BASED ON THE LANDSCAPE ARCHITECT'S OBSERVATIONS BUT IS NOT INTENDED TO AND DOES NOT ALTER THE SURVEY INFORMATION. REFER TO SURVEY NOTES FOR ADDITIONAL INFORMATION.
2. SAW CUT FOR PAVING REMOVALS. EXTEND REMOVAL LINES TO INCLUDE ANY ADJOINING BROKEN OR DETERIORATING PAVING. CAREFULLY REMOVE STOCKPILE AND PROTECT ANY ITEMS NOTED FOR SALVAGE. ALL DEMOLITION RUBBLE, DEBRIS AND EXCESS SOILS TO BE PROMPTLY REMOVED FROM SITE. STRIP AND STOCKPILE SUFFICIENT EXISTING ORGANIC TOPSOILS FOR RESPREADING AS REQUIRED ON DISTURBED AND REGRADED AREAS TO BE ESTABLISHED AS LAWN AND FOR REPAIR OF DISTURBED EXISTING LAWNS TO REMAIN. STOCKPILE ALL MATERIALS IN APPROVED LOCATIONS WITHOUT INTERFERING WITH OTHER CONTRACTOR WORK, SCHOOL TRAFFIC OR DRAINAGE.
3. ALL FILL/BACKFILL OF EXCAVATIONS AND VOIDS RESULTING FROM REMOVALS AND RELATED WORK UNDER PROPOSED OR REPLACEMENT PAVING AREAS SHALL ONLY BE COARSE AGGREGATE FILL OR SUBBASE COURSE MATERIAL THOROUGHLY COMPACTED.
4. PROTECT ALL FACILITIES AND IMPROVEMENTS ON AND ADJOINING THE PROPERTY WHICH ARE NOT SPECIFICALLY IDENTIFIED FOR REMOVAL. VERIFY LOCATIONS AND DEPTHS OF ALL SUBSURFACE UTILITIES TO REMAIN PRIOR TO ANY ADJACENT REMOVAL AND EXCAVATION WORK.

5. ALL EXISTING FEATURES SHALL REMAIN UNLESS OTHERWISE NOTED. IF THE CONTRACTOR DAMAGES ANY OF THE EXISTING ON-SITE FACILITIES TO REMAIN (TREES, PAVEMENTS, UNDERGROUND UTILITIES, STRUCTURES, ETC.) WHETHER SHOWN ON THE PLANS OR NOT, THE CONTRACTOR SHALL REPAIR AND/OR REPLACE SUCH ITEMS AT HIS OWN EXPENSE AND ASSUME ALL RESPONSIBILITY FOR SUCH DAMAGE WITHOUT ANY ADDITIONAL COST TO THE OWNER. REPLACEMENT MATERIAL SHALL BE SAME QUALITY AND QUANTITY AS ORIGINAL.
6. THE CONTRACTOR SHALL CONFIRM EXISTING GRADES AND LOCATIONS OF ALL EXISTING FEATURES WITHIN THE CONTRACT LIMIT LINE. THE CONTRACTOR SHALL CONTACT THE LANDSCAPE ARCHITECT IMMEDIATELY SHOULD ANY DISCREPANCIES BE FOUND AT (315) 445-1980.
7. ADJUST RIMS OF UTILITY STRUCTURES TO REMAIN WITHIN AREAS OF GRADE CHANGES TO MEET PROPOSED LINES AND GRADES.
8. ALL NON-PAVED AREAS ARE TO BE LAWN UNLESS OTHERWISE NOTED.
9. CONTRACTOR SHALL BLEND NEW WORK SMOOTHLY AND EVENLY WITH EXISTING LINES AND GRADES.
10. CONTRACTOR SHALL BE RESPONSIBLE FOR LAWN MAINTENANCE WITHIN THE CONTRACT LIMIT LINE. EXISTING LAWNS SHALL BE MOVED AS MUCH AS PRACTICAL TO KEEP AREA FROM LOOKING UNSIGHTLY. ALL TRASH AND DEBRIS SHALL BE PICKED UP AND DISPOSED OF PROPERLY.

L11-MSTR-GEN-NOTES

## LEGEND

EXISTING	PROPOSED	DESCRIPTION
100		CONTOUR
+377.7		SPOT ELEVATION
CT/CE		CURB TAPER/END
TC/BC		TOP/BOTTOM OF CURB
HP/LP		HIGH / LOW POINT
		GUIDERAIL
		FENCE
		UTILITY POLE
		WATER LINE
		FIRE HYDRANT
		FORCE MAIN
		STORM PIPE
		UNDERDRAIN
		SANITARY PIPE
		OVERHEAD ELECTRIC
		UNDERGROUND ELECTRIC
		TELEPHONE
		FORCE MAIN MANHOLE
		STORM STRUCTURE
		DRYWELL
		STORM INLET
		CATCH BASIN/MANHOLE
		CLEAN OUT
		SANITARY MANHOLE
		ASPHALT PAVEMENT-PARKING
		HEAVY DUTY CONCRETE PAVEMENT
		CONCRETE PAVEMENT
		OUTLET PROTECTION
		TRAFFIC SIGN
		TRAFFIC SIGN SET IN BOLLARD
		LIGHT POLE (REFER TO ELEC. PLANS)
		CURB
		CURB FLUSH (1" REVEAL UNLESS OTHERWISE NOTED)
		SILT FENCE
		TREE
		SHRUB
		PLANT KEY
		VEGETATION

## EXISTING CONDITIONS & REMOVAL/DEMOLITION NOTES

1. SAWCUT EXISTING ASPHALT OR CONCRETE PAVEMENT. SAWCUT ASPHALT IN NEAT STRAIGHT LINE AND SAWCUT CONCRETE PAVEMENT AT NEAREST SCORE JOINT.
2. REMOVE EXISTING ASPHALT PAVEMENT, INCLUDING SUBBASE MATERIAL, AND DISPOSE OF OFF SITE.
3. REMOVE EXISTING CONCRETE CURB AND DISPOSE OF OFF SITE.
4. REMOVE EXISTING CONCRETE PAVEMENT, INCLUDING SUBBASE MATERIAL, AND DISPOSE OF OFF SITE.
5. REMOVE EXISTING FENCE, INCLUDING POSTS, FABRIC AND FOOTINGS AND DISPOSE OF OFF SITE.
6. REMOVE EXISTING TREE / VEGETATION (INCLUDING STUMPS AND ROOTS), DEBRIS, GARBAGE, PLASTIC, ETC. AND DISPOSE OF OFF SITE.
7. BRUSH HOG VEGETATION PRIOR TO STRIPPING TOPSOIL. STRIP EXISTING TOPSOIL AND STOCKPILE ON SITE FOR REUSE. COORDINATE STOCKPILE LOCATION WITH OWNER OR CM. ALL EXCESS TOPSOIL SHALL BE REMOVED FROM THE SITE.
8. NO STOCKPILING OF MATERIALS, INCLUDING SOIL, STONE OR BUILDING MATERIALS, IS ALLOWED WITHIN THE NATIONAL GRID EASEMENT. NO PARKING OF ANY EQUIPMENT OR VEHICLES IS ALLOWED IN THE EASEMENT. A SPOTTER WITH AIR HORN MUST BE UTILIZED WHEN WORKING WITHIN THE EASEMENT AREA. THE EASEMENT IS TO BE DELINEATED WITH SIGNAGE AND OR BARRIERS AND CONES TO CLEARLY DEFINE THE EASEMENT AREA. EXCAVATORS AND DUMP BOXES ARE NOT ALLOWED IN THE EASEMENT AREA TO REDUCE RISK AROUND POWER LINES.

L11-KFA-LEGEND



**KEPLINGER FREEMAN ASSOCIATES**  
LANDSCAPE ARCHITECTURE & LAND PLANNING  
6320 FLY ROAD, SUITE 109 EAST SYRACUSE, NEW YORK 13057  
PHONE: (315) 445-7980 FAX: (315) 445-7981

**RZ Engineering, PLLC**  
SYRACUSE OFFICE  
6320 FLY ROAD SUITE 109  
EAST SYRACUSE, NY 13057  
PH: 315.432.1089



## ISSUED FOR PERMIT

REV. NO.	DATE	DRAWN BY	DESCRIPTION

ALL DRAWINGS AND SPECIFICATIONS ARE THE PROPERTY OF THE ARCHITECT AND SHALL BE USED ONLY ON THE JOB DESIGNATED. COPYRIGHT ©  
THE CONTRACTOR SHALL VERIFY ALL DIMENSIONS AT THE SITE AND PROMPTLY NOTIFY THE ARCHITECT IN WRITING OF ANY DISCREPANCIES.

JOB NO: 22050 SHARES NO: 20240329 DATE: 07/18/25 DRAWN BY: EK SCALE: SEE DRAWING
--

## RIVER STREET SENIOR HOUSING

30 RIVER STREET, CORTLAND, NEW YORK

**HOLMES • KING • KALLOUST**  
& Associates, Architects, LLP  
575 NORTH SALINA STREET, SYRACUSE, NY 13208  
PH: (315) 476-8371 FAX: (315) 476-5420  
www.hkkarchitects.com

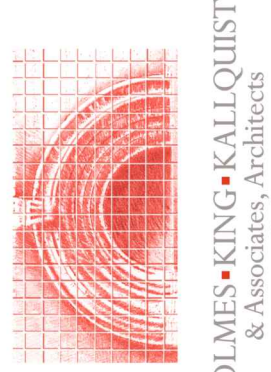

## SITE PREPARATION PLAN

# L1.1

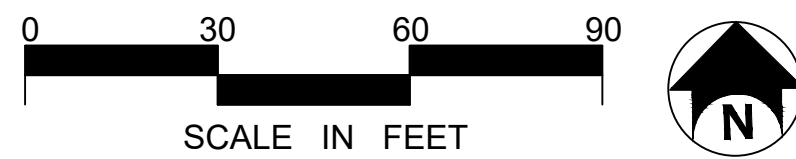



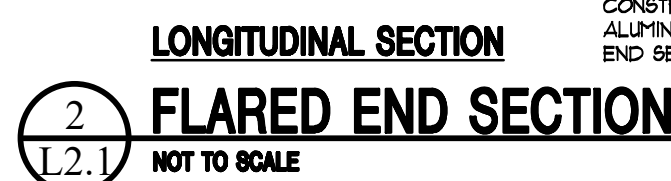

NOTES:  
1. ALL SECTIONS REINFORCED PRECAST CONCRETE DESIGNED FOR H-20 LOADING.  
2. HEIGHT OF DRYWELL CHAMBER PER PLAN.  
3. BE - BOTTOM ELEVATION. REFER TO PLAN.

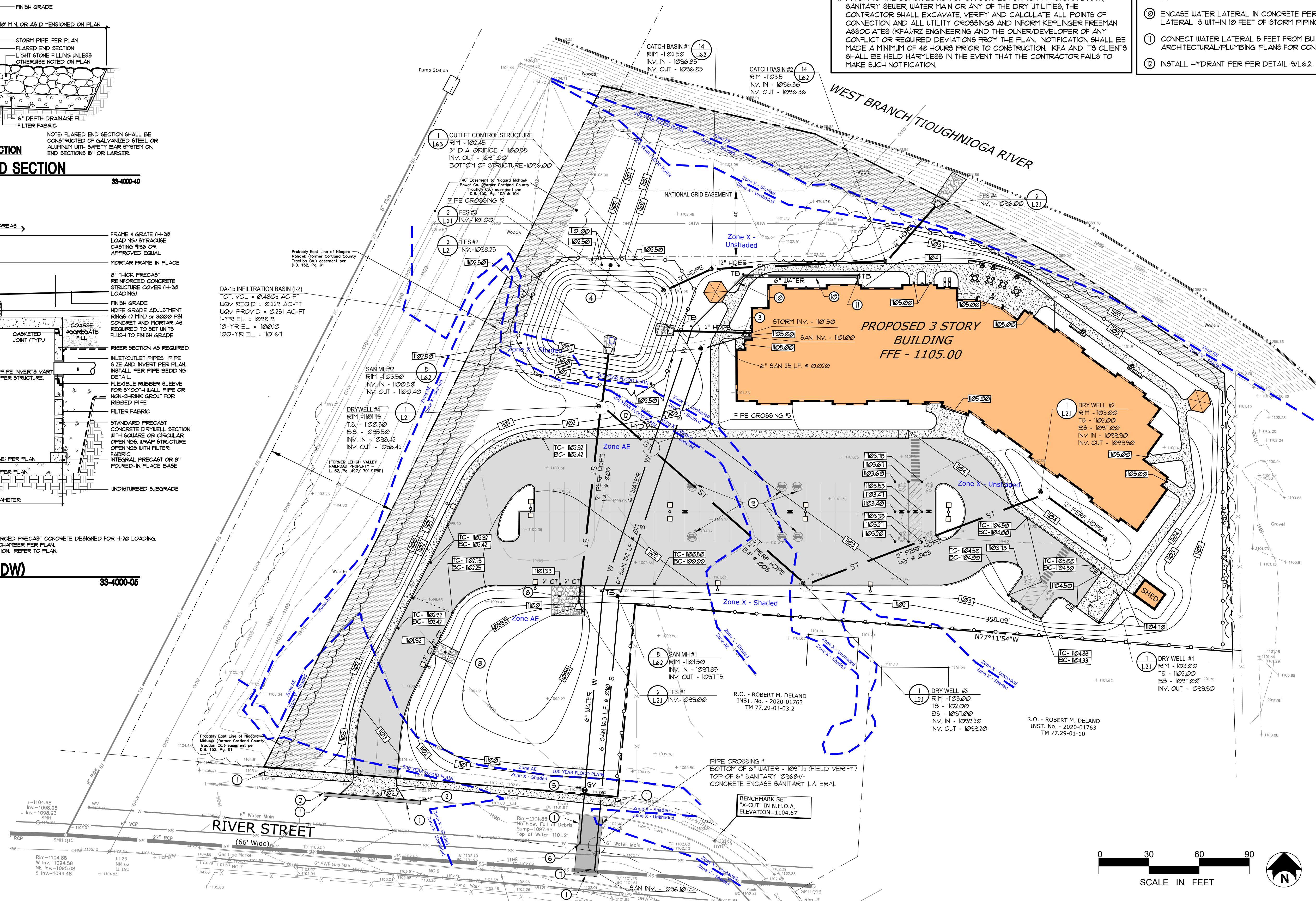

1. ANY/ALL FILL REQUIRED BELOW PAVING SUBGRADE SHALL ONLY BE COARSE AGGREGATE FILL OR SUBBASE COURSE MATERIALS.
2. WHEREVER EXISTING STORM STRUCTURES ARE TO BE ABANDONED AND REMOVED, CUT AND PLUG CONNECTING PIPES AND/OR REMOVE PORTIONS OF PIPES WHICH MAY INTERFERE WITH OTHER WORK.
3. ALL CONCRETE PAVING AT ALL DOORS SHALL BE FLUSH WITH BUILDING FLOOR ELEVATION. CONCRETE PAVEMENT SHALL BE DOULED TO FOUNDATION WALL PER DETAILS.
4. CONTRACTOR SHALL COORDINATE ANY DISRUPTIONS TO EXISTING UTILITY SERVICES WITH ADJACENT PROPERTY OWNERS.
5. ALL ELECTRIC AND TELEPHONE EXTENSIONS INCLUDING SERVICE LINES SHALL BE CONSTRUCTED TO THE APPROPRIATE UTILITY COMPANY SPECIFICATIONS. ALL UTILITY DISCONNECTIONS SHALL BE COORDINATED WITH THE DESIGNATED UTILITY COMPANIES.
6. CONSTRUCTION SHALL NOT START ON ANY PUBLIC UTILITY SYSTEM UNTIL WRITTEN APPROVAL HAS BEEN RECEIVED BY THE ENGINEER FROM THE APPROPRIATE GOVERNING AUTHORITY AND THE CONTRACTOR HAS BEEN NOTIFIED BY THE ENGINEER.
7. PRIOR TO THE CONSTRUCTION OF OR CONNECTION TO ANY STORM DRAIN, SANITARY SEWER, WATER MAIN OR ANY OF THE DRY UTILITIES, THE CONTRACTOR SHALL EXCAVATE, VERIFY AND CALCULATE ALL POINTS OF CONNECTION AND ALL UTILITY CROSSINGS AND INFORM KEPLINGER FREEHMAN ASSOCIATES (KFA) ENGINEERING AND THE OWNER/DEVELOPER OF ANY CONFLICT OR REQUIRED DEVIATIONS FROM THE FINAL NOTIFICATION SHALL BE MADE A MINIMUM OF 48 HOURS PRIOR TO CONSTRUCTION. KFA AND ITS CLIENTS SHALL BE HELD HARMLESS IN THE EVENT THAT THE CONTRACTOR FAILS TO MAKE SUCH NOTIFICATION.

- ① MEET EXISTING LINE AND GRADE.
- ② MEET TOP AND FACE OF EXISTING CURB.
- ③ INSTALL COMMERCIAL VENT AND TRAP PER DETAIL 4/L6.2.
- ④ INSTALL SPILLWAY PER DETAIL 3/L6.2.
- ⑤ INSTALL 6" GATE VALVE PER DETAIL 6/L6.2.
- ⑥ INSTALL 6" WATER LINE PER DETAIL 2/L6.2. COORDINATE CONNECTION OF NEW WATER LINE TO EXISTING CITY WATER LINE WITH CITY OF CORTLAND WATER DEPARTMENT. PROVIDE THRUST BLOCKS PER DETAIL 8/L6.2 AS REQUIRED
- ⑦ CORE DRILL AND INSTALL ADS INSERT-A-TEE AT EXISTING SANITARY MAIN. PROVIDE BYPASS PUMPING OF SANITARY SEWER MAIN AS REQUIRED TO INSTALL INSERT-A-TEE.
- ⑧ INSTALL STONE LINED SUALLE PER DETAIL 7/L6.2.
- ⑨ APPROXIMATE LOCATION OF NEW E/V CHARGING STATION. SITE CONTRACTOR TO INSTALL CHARGING STATION. ALL ELECTRICAL WORK TO BE DONE BY ELECTRICAL CONTRACTOR. REFER TO ELECTRICAL DRAWINGS.
- ⑩ ENCASE WATER LATERAL IN CONCRETE PER DETAIL 10/L6.2 WHERE LATERAL IS WITHIN 10 FEET OF STORM PIPING.
- ⑪ CONNECT WATER LATERAL 5 FEET FROM BUILDING FACE. REFER TO ARCHITECTURAL/PLUMBING PLANS FOR CONTINUATION INSIDE BUILDING.
- ⑫ INSTALL HYDRANT PER DETAIL 9/L6.2.

[illegible]

# RIVER STREET SENIOR HOUSING

# SITE GRADING, DRAINAGE AND UTILITIES PLAN

# L2.1



ZONING DATA			
ZONING: GENERAL BUSINESS LOCAL (GB-2)			
INTENDED USE AS MULTIFAMILY RESIDENTIAL (SENIOR HOUSING) IS ALLOWABLE BY CODE			
PROPOSED BUILDING FOOTPRINT IS 10,513 SF			
MIN. BUILDING HEIGHT:	CITY CODE 22 FEET	PROPOSAL OVER 22 FEET	VARIANCE N/A
MAX. BUILDING HEIGHT:	45 FEET	UNDER 45 FEET	N/A
MIN. LOT SIZE:	10,000 SF	133,903 ± SF	N/A
MIN. LOT WIDTH:	100 FEET	165'-9" FEET	N/A
MAX. LOT COVERAGE:	60%	45.8% (60,619 SF)	N/A
MIN. FRONT YARD SETBACK:	25 FEET	61'-1" FEET	N/A
SIDE YARD SETBACK:	15 FEET	35'-9" FEET	N/A
REAR YARD SETBACK:	20 FEET	36'-1" FEET	N/A
PARKING REQUIREMENTS:	15 PER DU	54 SPACES	1 / UNIT
9X15' STALLS REQUIRED, 9X10 SHOWN			
15 PARKING SPACES/UNIT X 53 DWELLING UNITS = 80 SPACES			

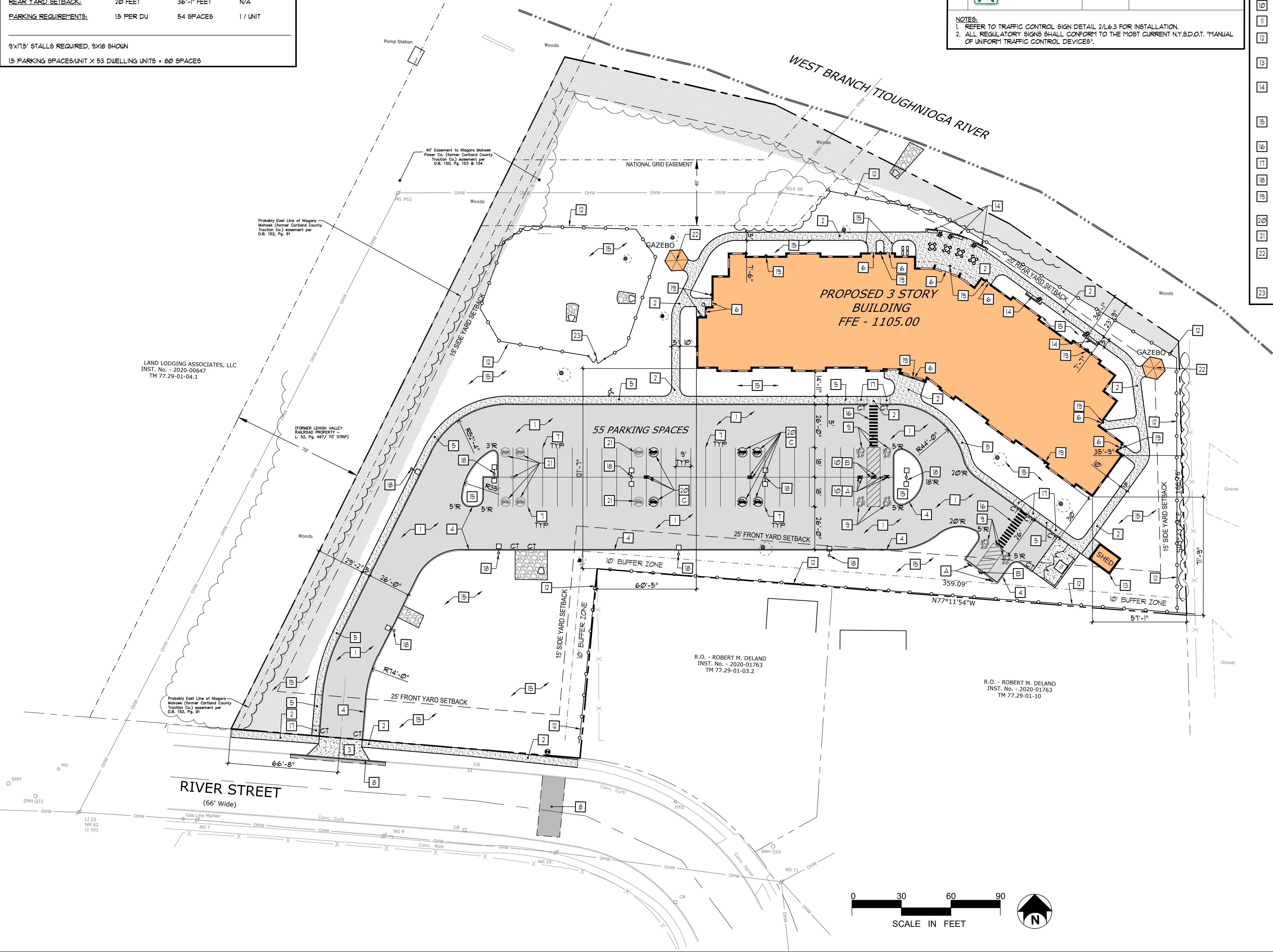

SIGN SCHEDULE			
KEY	SIGN PLATE	SIGN SIZE MOUNTING HT.	NYSDOT MUTCD NO. / COMMENTS
A		12" x 18" 7'-0" HT.	SIGN NO: P4-6 COLORS: WHITE BACKGROUND, BLUE ICON, GREEN TEXT/ BORDER COMMENTS:
B		12" x 18" 7'-0" HT.	SIGN NO: - COLORS: WHITE BACKGROUND, RED TEXT AND BORDER
C		12" x 18" 7'-0" HT.	SIGN NO: - K-1190-B COLORS: WHITE BACKGROUND, GREEN TEXT AND BORDER
NOTES: 1. REFER TO TRAFFIC CONTROL SIGN DETAIL 2/L6.3 FOR INSTALLATION. 2. ALL REGULATORY SIGNS SHALL CONFORM TO THE MOST CURRENT NYSDOT "MANUAL OF UNIFORM TRAFFIC CONTROL DEVICES".			

- LAYOUT CONSTRUCTION NOTES
1. INSTALL ASPHALT PARKING PAVEMENT PER DETAIL 1/L6.1.
  2. INSTALL CONCRETE PAVEMENT PER DETAIL 2/L6.1.
  3. INSTALL CONCRETE PAVEMENT-HEAVY DUTY PER DETAIL 16/L6.1.
  4. INSTALL CONCRETE CURB PER DETAIL 5/L6.1.
  5. INSTALL INTEGRAL CONCRETE CURB AND PAVEMENT PER DETAIL 6/L6.1.
  6. INSTALL CONCRETE DOUELING AT BUILDING PER DETAIL 9/L6.1.
  7. INSTALL WHITE 4" WIDE PAINTED LINES, (TYP.)
  8. INSTALL ASPHALT DRIVE PAVEMENT PER DETAIL 2/L3.1.
  9. INSTALL RESERVED PARKING PER DETAIL 11/L6.1.
  10. INSTALL SIGN POST SET IN BOLLARD PER DETAIL 13/L6.1.
  11. INSTALL WASTE/RECYCLING ENCLOSURE PER DETAIL 15/L6.1.
  12. INSTALL 4 FOOT HEIGHT BLACK VINYL COATED CHAIN LINK FENCE PER DETAIL 17/L6.1.
  13. 12' X 16' MAINTENANCE SHED BY OWNER (NOT IN CONTRACT). SHOWN FOR COORDINATION PURPOSES ONLY.
  14. PERMANENTLY SURFACE MOUNT 6 FT. BENCH PER MANUFACTURER'S RECOMMENDATIONS WHERE INDICATED ON THE PLAN. REFER TO SPECIFICATION 32 4000 FOR BENCH MODEL.
  15. INSTALL SEEDED LAWN PER DETAIL 14/L6.1 IN ALL DISTURBED AREAS UNLESS OTHERWISE NOTED.
  16. INSTALL PAINTED CROSSWALK PER DETAIL 12/L6.1.
  17. INSTALL ACCESSIBLE RAMP PER DETAIL 8/L6.1.
  18. INSTALL LIGHT POLE BASE PER DETAIL 1/L1.1. REFER TO PHOTOMETRIC PLAN.
  19. LIGHTING ON BUILDING SHOWN FOR COORDINATION PURPOSES. REFER TO PHOTOMETRIC AND ARCHITECTURAL PLANS.
  20. INSTALL EV CHARGING STATION PER MANUFACTURER'S RECOMMENDATIONS.
  21. LOCATION OF FUTURE EV CHARGING STATION.
  22. INSTALL 12 FOOT WOOD GAZEBO (NOT IN CONTRACT) ON CONCRETE PAD PER MANUFACTURER'S RECOMMENDATIONS. GAZEBO SHALL HAVE TRANSITION AT ENTRANCE FOR WHEELCHAIR ACCESS. SHOWN FOR COORDINATION PURPOSES ONLY.
  23. INSTALL 10 FOOT WIDE DOUBLE CHAIN LINK SWING GATE PER DETAIL 3/L6.3.

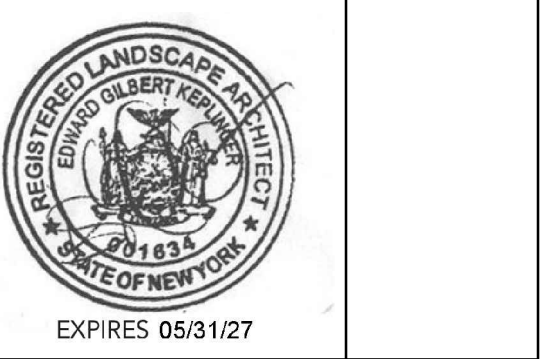
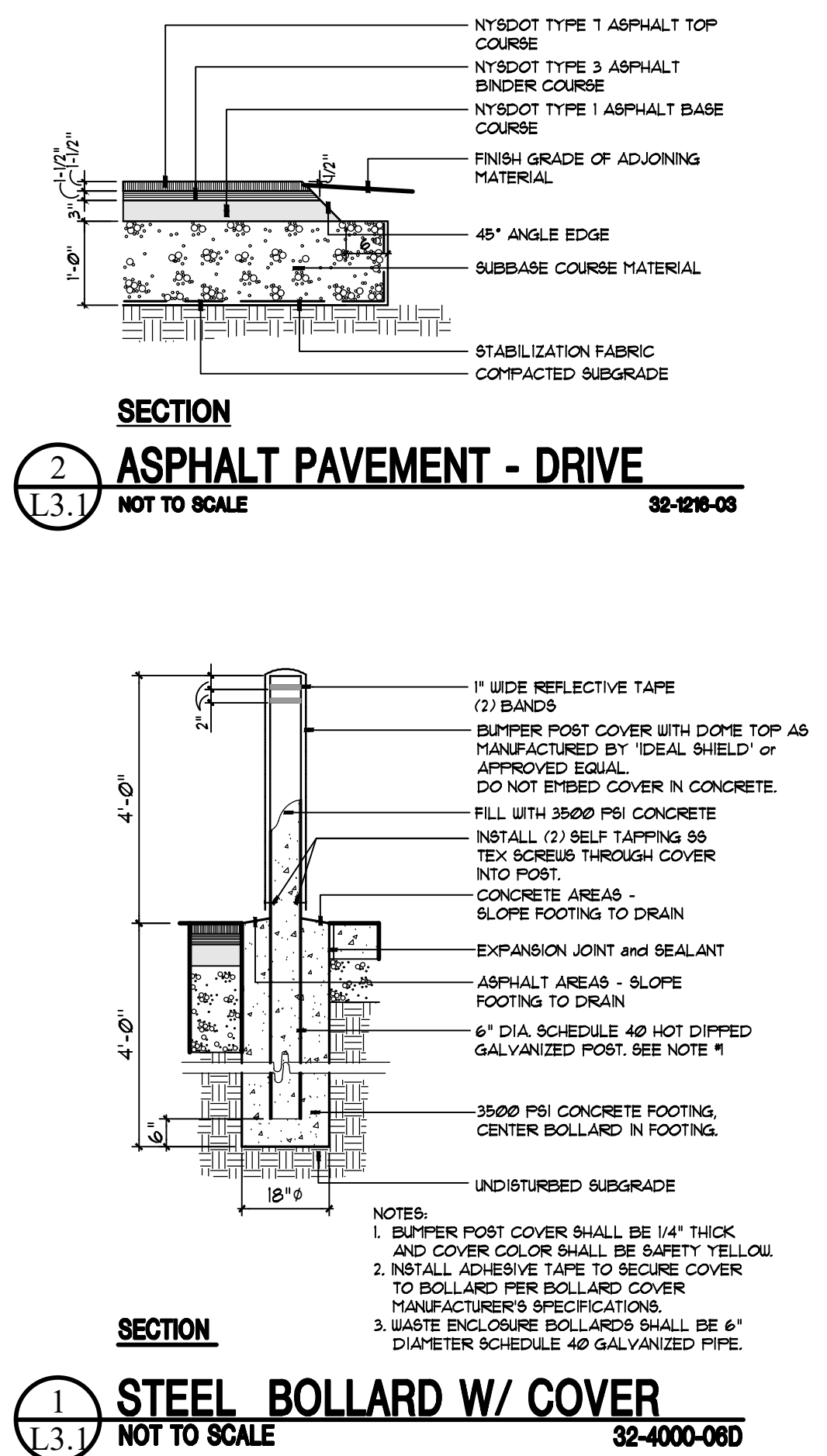

**KEPLINGER FREEMAN ASSOCIATES**  
LANDSCAPE ARCHITECTURE & LAND PLANNING  
6320 ELY ROAD, SUITE 109 EAST SYRACUSE, NEW YORK 13057  
PHONE: (315) 445-7980 FAX: (315) 445-7981

**RZ Engineering, PLLC**  
1100 W. 10TH AVE. SUITE 100  
EAST SYRACUSE, NY 13057  
PH: 315.432.1089



ISSUED FOR PERMIT

REV. NO.	DATE	DRAWN BY	DESCRIPTION

ALL DRAWINGS AND SPECIFICATIONS ARE THE PROPERTY OF THE ARCHITECT, AND SHALL BE USED ONLY ON THE JOB DESIGNATED. COPYRIGHT © THE CONTRACTOR SHALL VERIFY ALL DIMENSIONS AT THE SITE AND PROMPTLY NOTIFY THE ARCHITECT IN WRITING OF ANY DISCREPANCIES.

JOB NO: 22050 SHARES NO: 20240329 DATE: 07/18/25 DRAWN BY: EK SCALE: SEE DRAWING
--

**RIVER STREET SENIOR HOUSING**  
30 RIVER STREET, CORTLAND, NEW YORK

**HOLMES • KING • KALLOUST & Associates, Architects, LLP**  
575 NORTH SALINA STREET, SYRACUSE, NY 13208  
PH: (315) 476-8371 FAX: (315) 476-5420  
www.hkkarchitects.com

**SITE LAYOUT PLAN**

**L3.1**



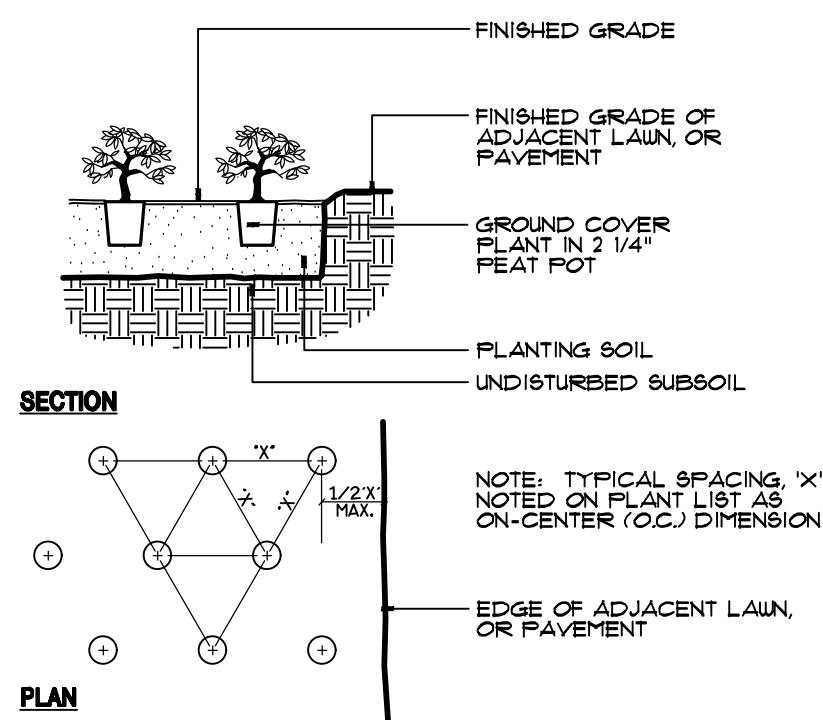
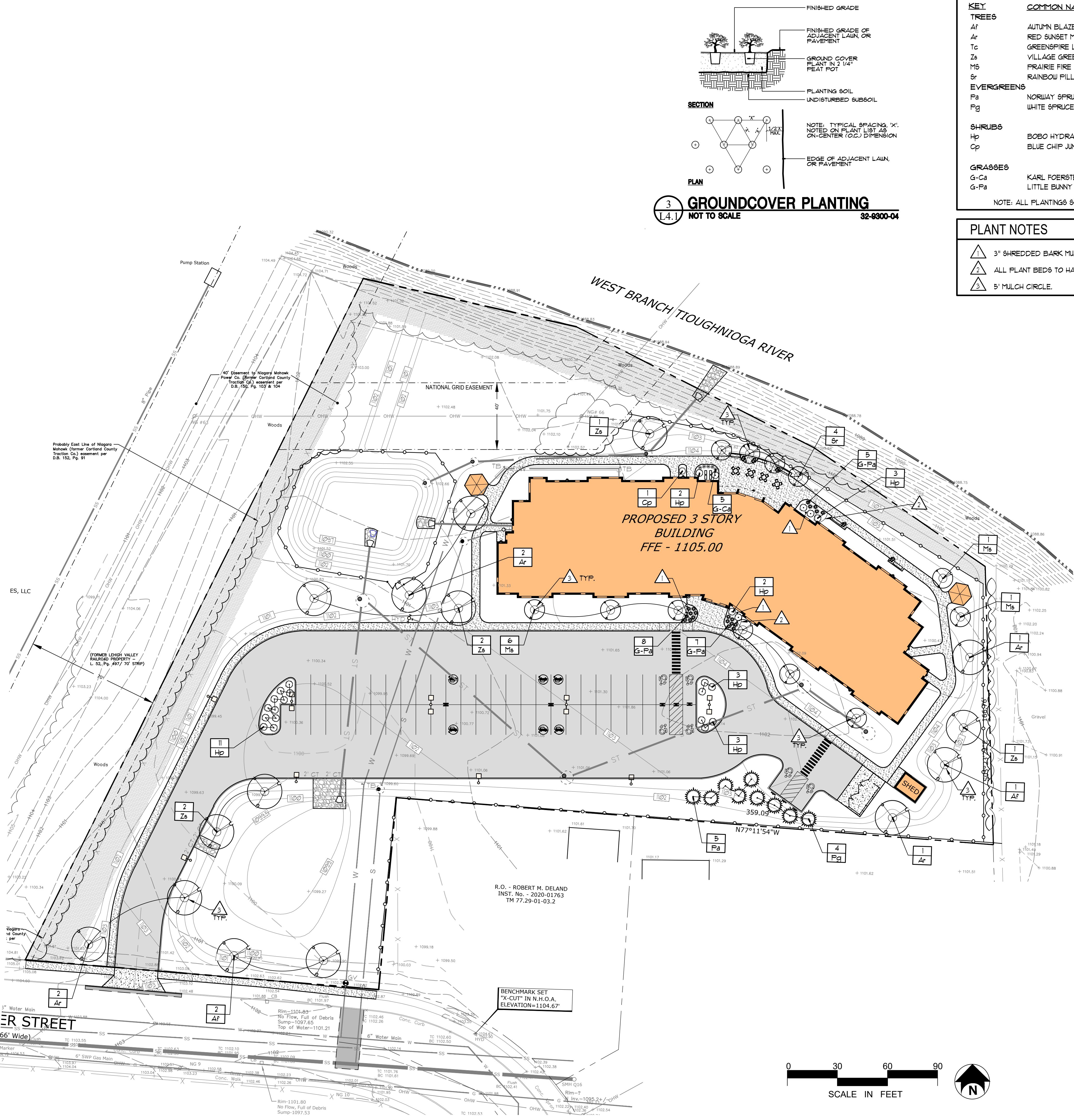

**GROUNDCOVER PLANTING**  
NOT TO SCALE  
32-0300-04

#### PLANT LIST

KEY	COMMON NAME	BOTANICAL NAME	CALIPER	HEIGHT	CONDITION	NOTE
<b>TREES</b>						
Ar	AUTUMN BLAZE RED MAPLE	ACER FREEMANII	2.5\" CAL.		B4B	
Ar	RED SUNSET MAPLE	ACER RUBRUM	2.5\" CAL.		B4B	
Tc	GREENSPIRE LINDEN	TILIA CORDATA 'GREENSPIRE'	2.5\" CAL.		B4B	
Zs	VILLAGE GREEN ZELKOVA	ZELKOVA SERRATA 'VILLAGE GREEN'	2.5\" CAL.		B4B	
Ms	PRAIRIE FIRE CRABAPPLE	MALUS 'PRAIRIE FIRE'	2.5\" CAL.		B4B	
Sr	RAINBOW PILLAR SERVICEBERRY	AMELANCHIER X RAINBOW PILLAR	1.5\" CAL.		B4B	
<b>EVERGREENS</b>						
Fa	NORWAY SPRUCE	PICEA ABIES		8'-10'	B4B	
Fg	WHITE SPRUCE	PICEA GLAUCA		8'-10'	B4B	
<b>SHRUBS</b>						
Hp	BOBO HYDRANGEA	HYDRANGEA PANICULATA 'LVOBO'			B4B	
Cp	BLUE CHIP JUNIPER	JUNIFERUS HORIZONTALIS BLUE CHIP			B4B	
<b>GRASSES</b>						
G-Ca	KARL FOERSTER FEATHER REED GRASS	CALAMAGROSTIS ACUTIFLORA 'KARL FOERSTER'	--	-	1 GAL.	
G-Pa	LITTLE BUNNY FOUNTAIN GRASS	FENISSETUM ALOPECUROIDES 'LITTLE BUNNY'			1 GAL.	

NOTE: ALL PLANTINGS SHALL BE NATIVE AND/OR NON-INVASIVE.

#### PLANT NOTES

- 3\" SHREDDED BARK MULCH WITH 10\" PLANT SOIL AS SPECIFIED.
- ALL PLANT BEDS TO HAVE SPADE CUT EDGES UNLESS OTHERWISE SPECIFIED.
- 5\" MULCH CIRCLE.

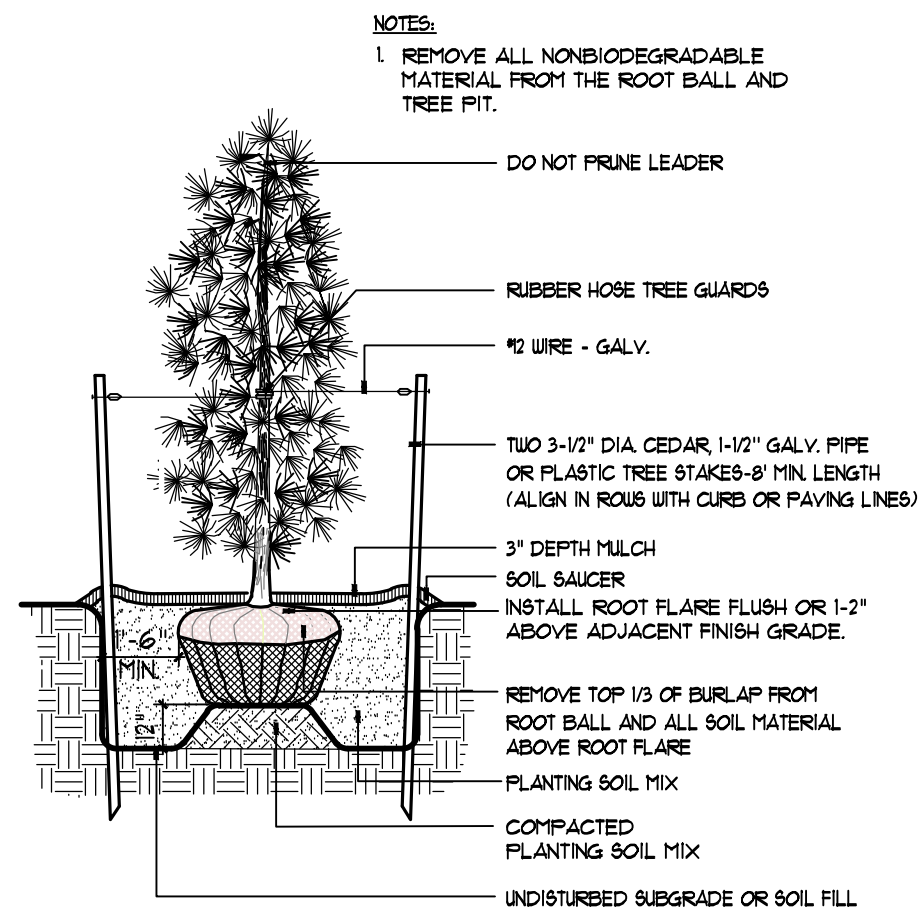

#### SECTION

#### EVERGREEN PLANTING

NOT TO SCALE  
32-0300-05

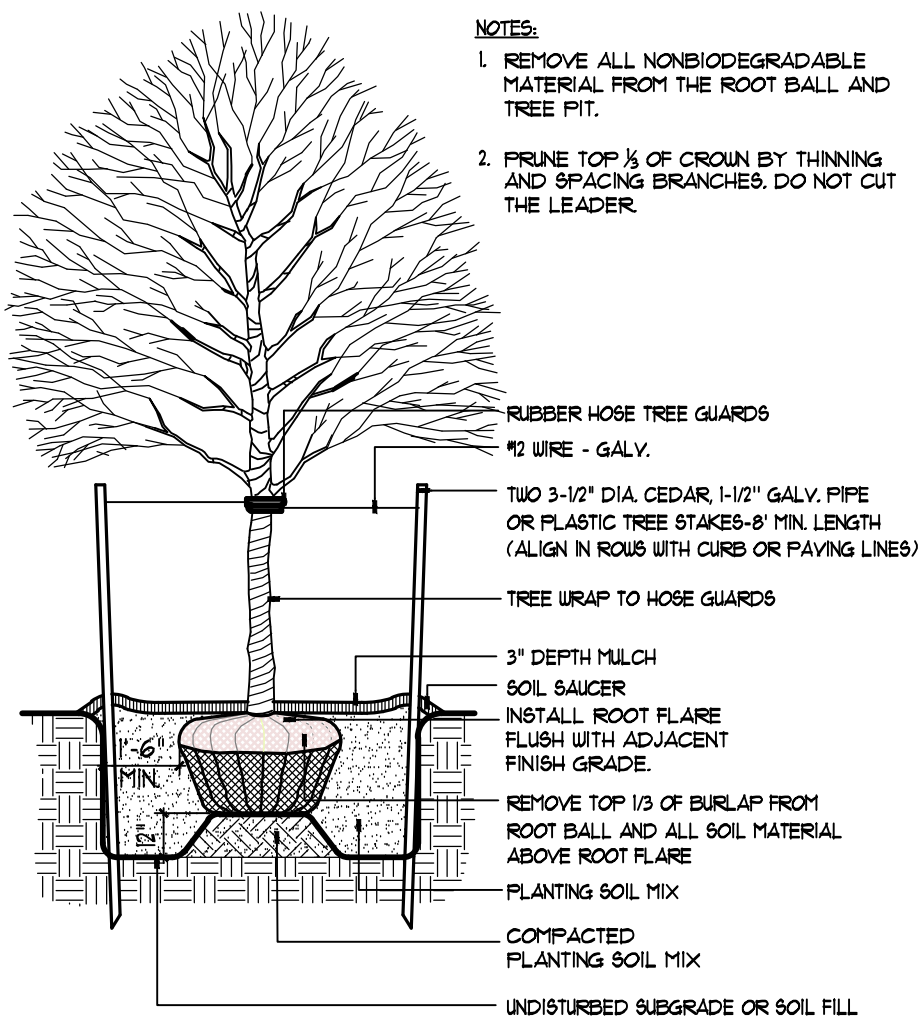

#### SECTION

#### TREE PLANTING

NOT TO SCALE  
32-0300-01



**KEPLINGER FREEMAN ASSOCIATES**  
LANDSCAPE ARCHITECTURE & LAND PLANNING  
6320 FLY ROAD, SUITE 109 EAST SYRACUSE, NEW YORK 13057  
PHONE: (315) 445-7980 FAX: (315) 445-7981

**RZ Engineering, PLLC**

6320 FLY ROAD SUITE 109  
EAST SYRACUSE, NY 13057  
PH: 315.432.1089



#### ISSUED FOR PERMIT

REV. NO.	DATE	DRAWN BY	DESCRIPTION

ALL DRAWINGS AND SPECIFICATIONS ARE THE PROPERTY OF THE ARCHITECT, AND SHALL BE USED ONLY ON THE JOB DESIGNATED. COPYRIGHT © THE CONTRACTOR SHALL VERIFY ALL DIMENSIONS AT THE SITE AND PROMPTLY NOTIFY THE ARCHITECT IN WRITING OF ANY DISCREPANCIES.

JOB NO: 22050 SHARES NO: 20240329 DATE: 07/18/25 DRAWN BY: EK SCALE: SEE DRAWING
--

#### RIVER STREET SENIOR HOUSING

30 RIVER STREET, CORTLAND, NEW YORK

**HOLMES • KING • KALLOUST**  
& Associates, Architects, LLP  
575 NORTH SALINA STREET, SYRACUSE, NY 13208  
PH: (315) 476-8371 FAX: (315) 476-5420  
www.hkkarchitects.com

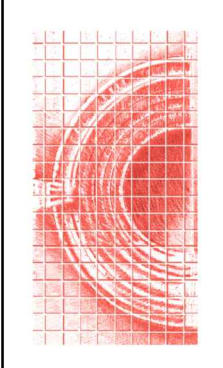

#### SITE PLANTING PLAN

# L4.1







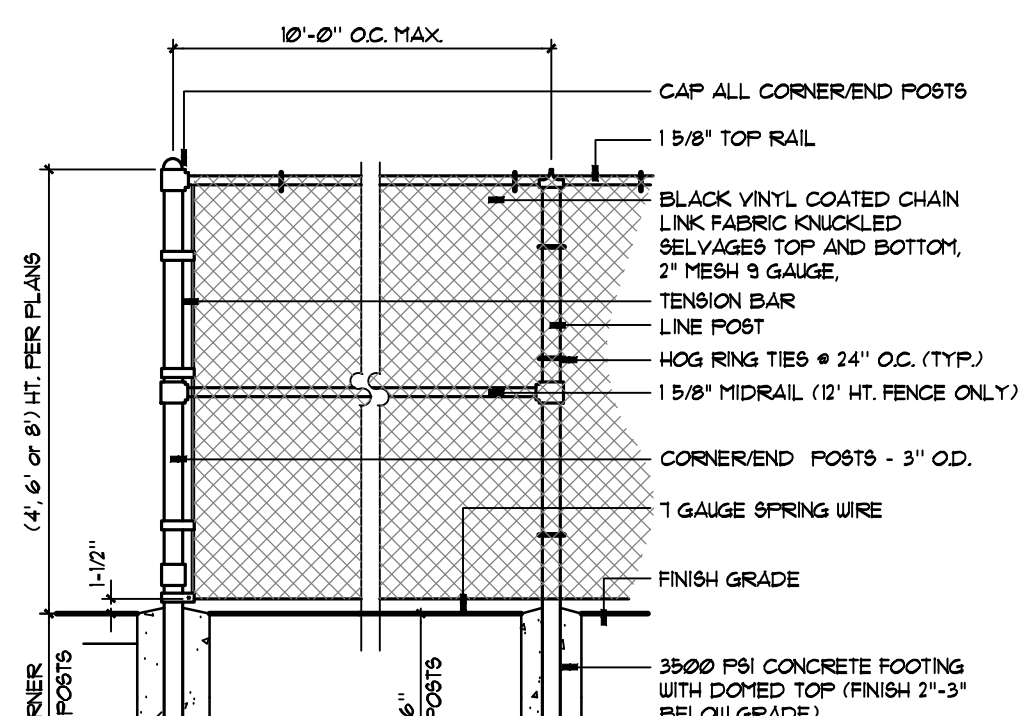
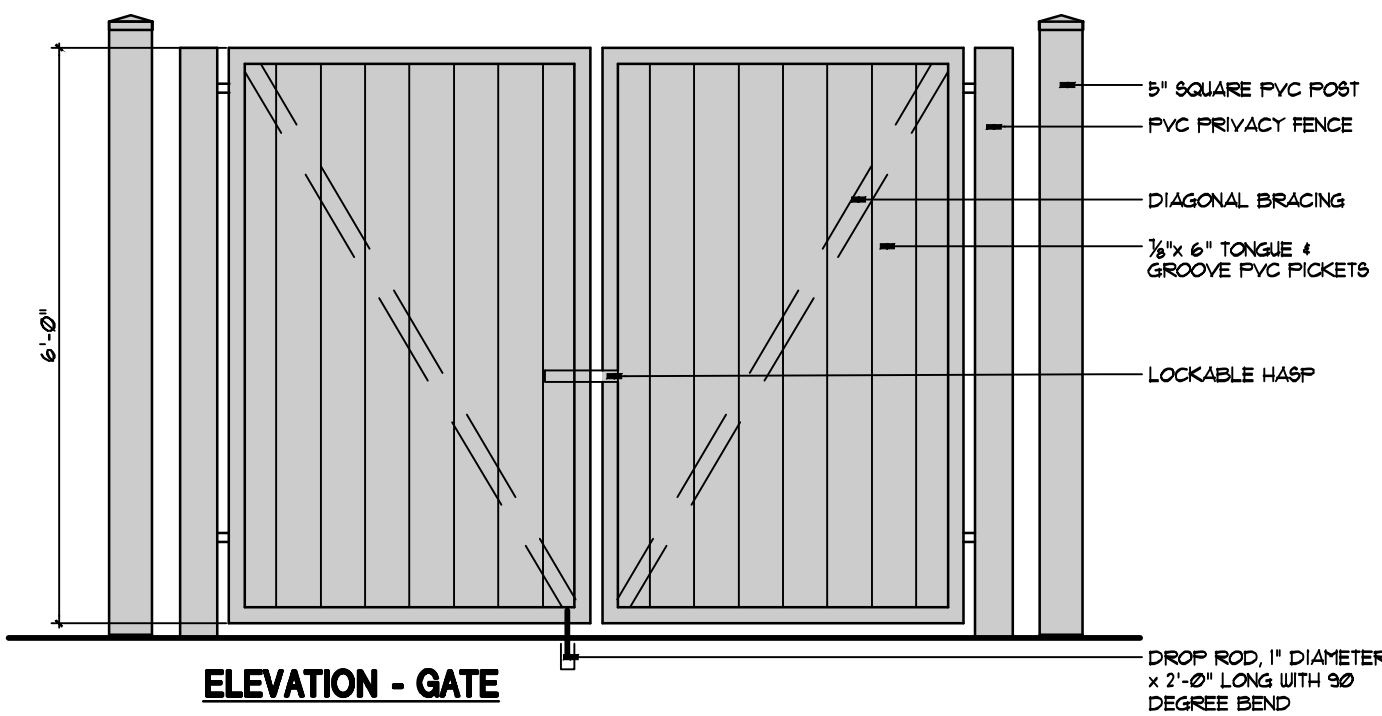

POST SCHEDULE		
FABRIC HEIGHT	LINE POST O.D.	END / CORNER POST O.D.
4'	2"	2 1/2"
6'	2 1/2"	3"
8'	3"	3 1/2"
12'	4"	4 1/2"

NOTES:  
1. HOLD TOP OF FOOTING AT ASPHALT BINDER SUBGRADE WHEN C.L. FENCE FOOTINGS ARE LOCATED IN ASPHALT PAVEMENT.

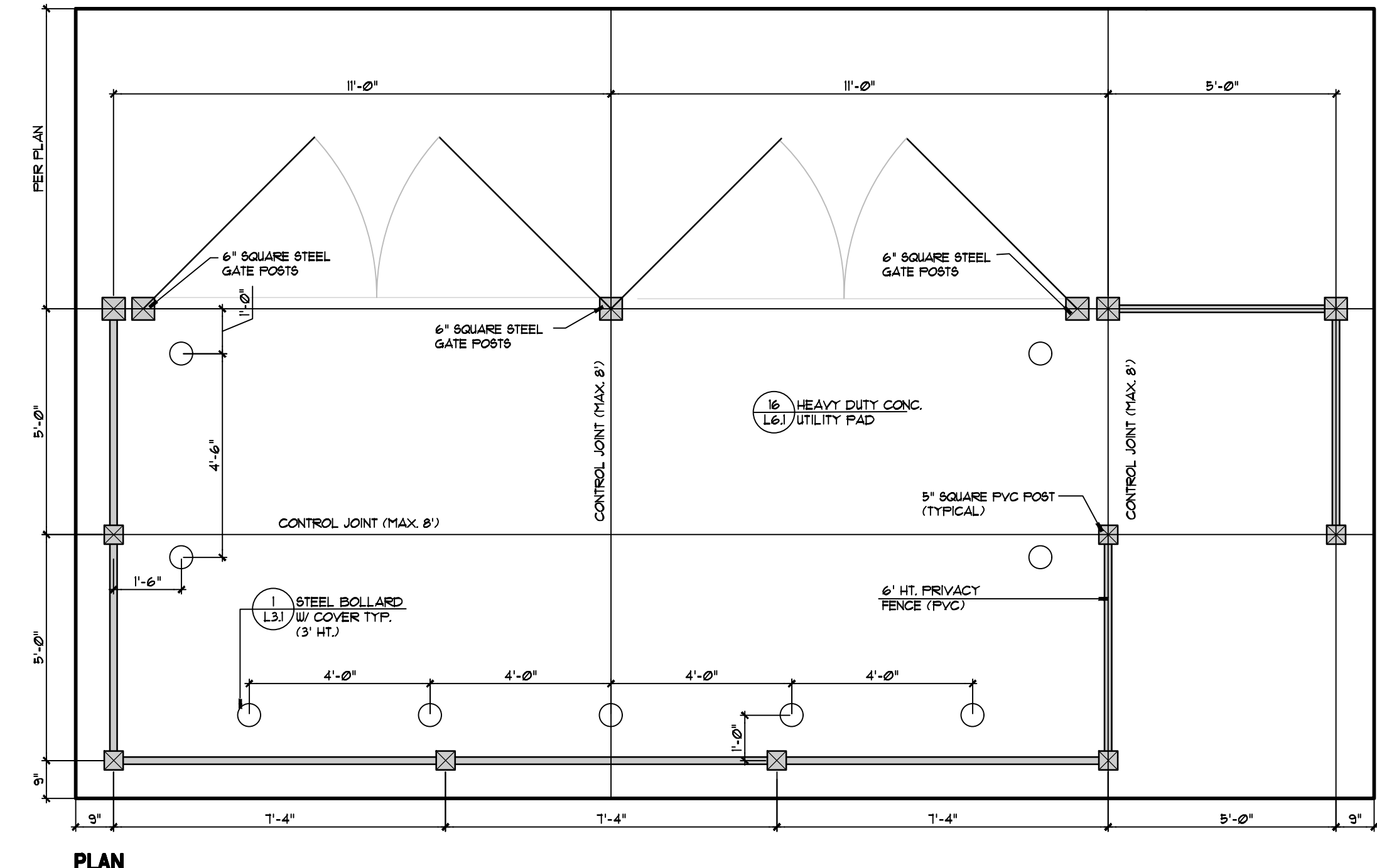
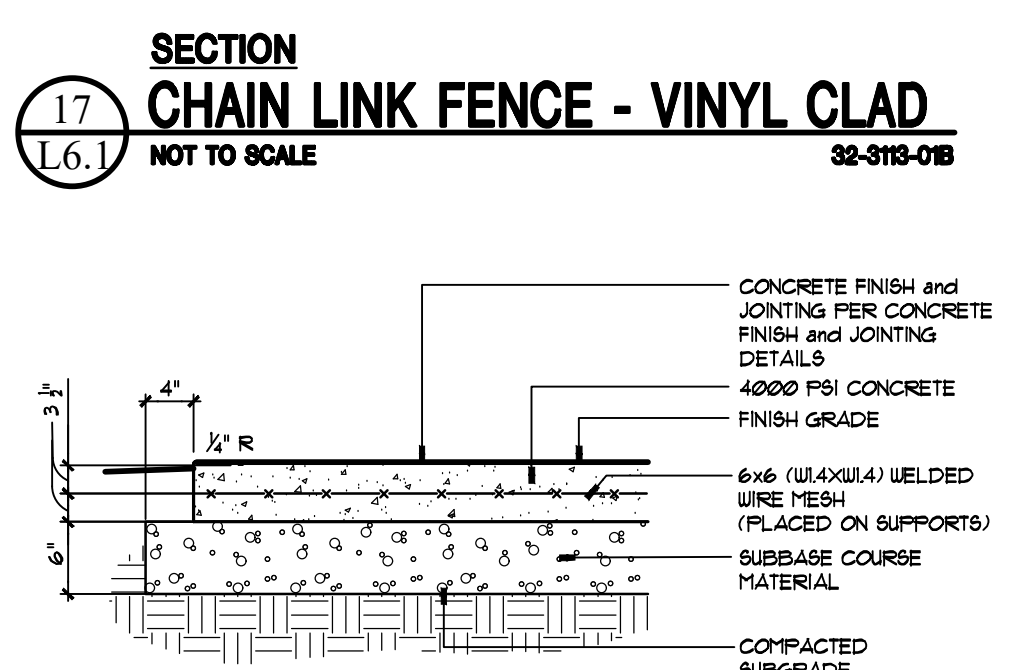

**15 WASTE/RECYCLING ENCLOSURE - VINYL**  
NOT TO SCALE 32-4001-028

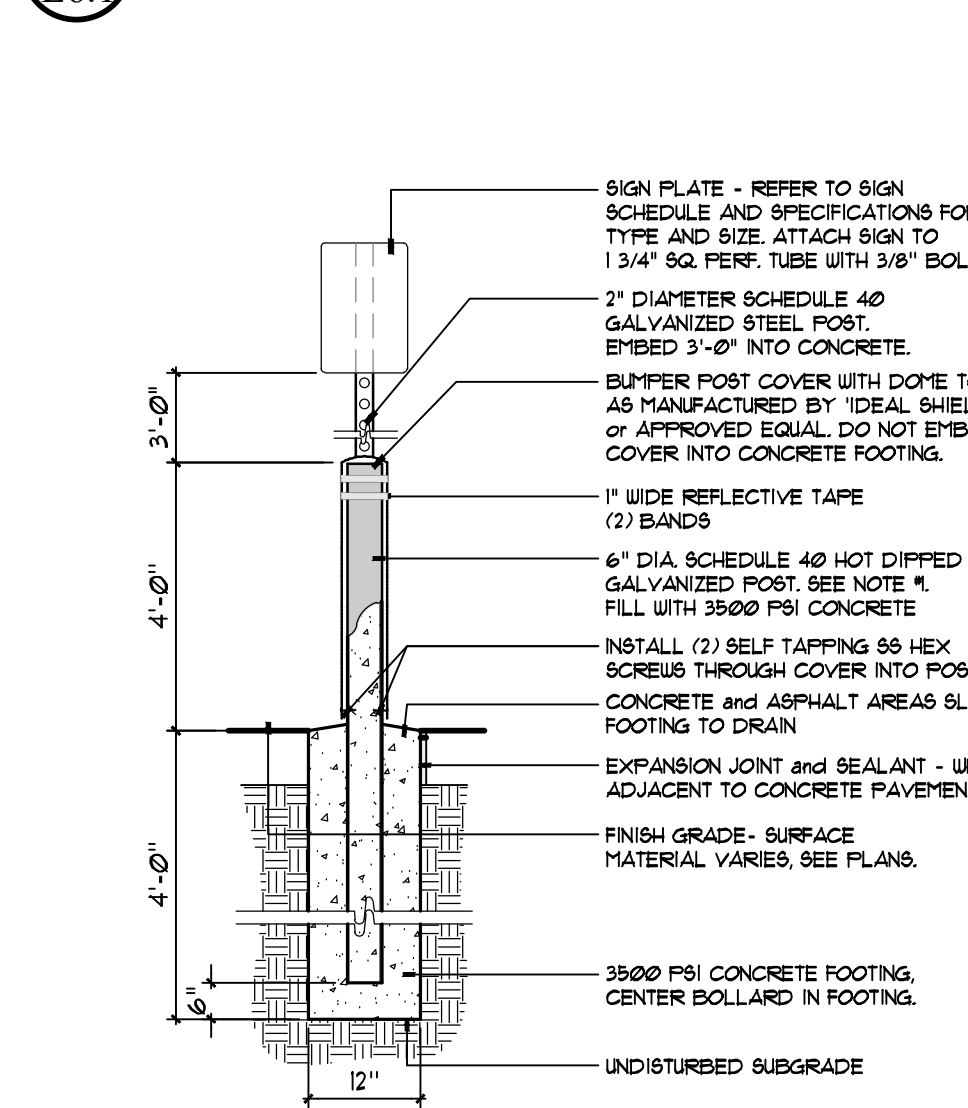
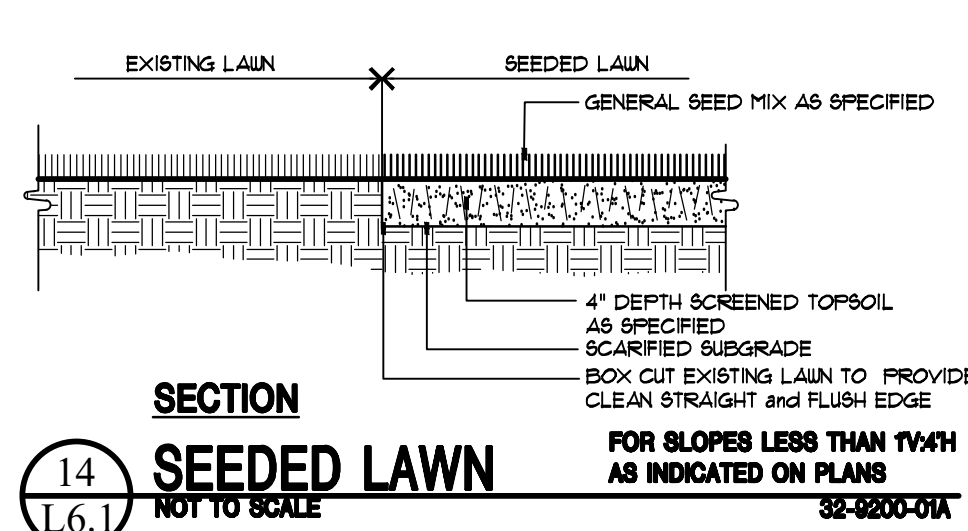

**13 TRAFFIC SIGN - SET IN BOLLARD**  
NOT TO SCALE 32-4000-02

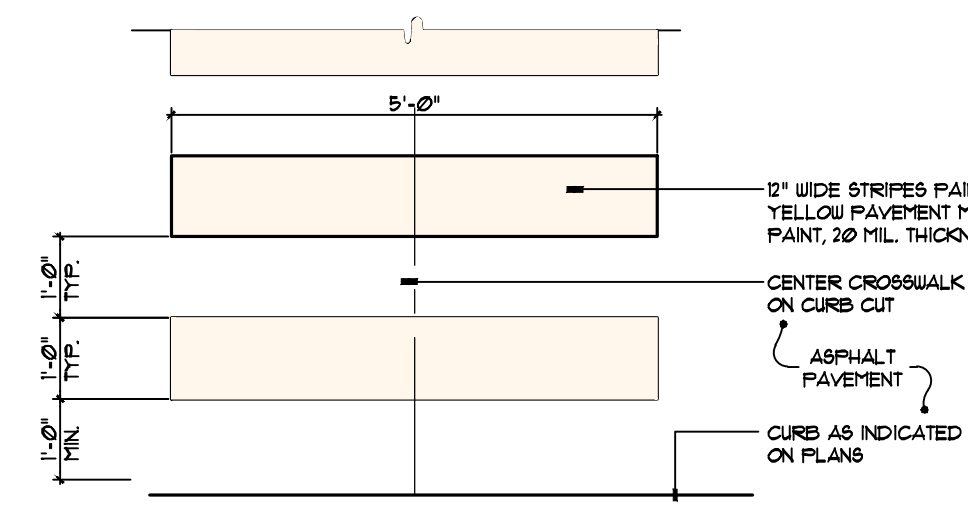

**12 PAINTED CROSSWALK**  
NOT TO SCALE 32-1723-02

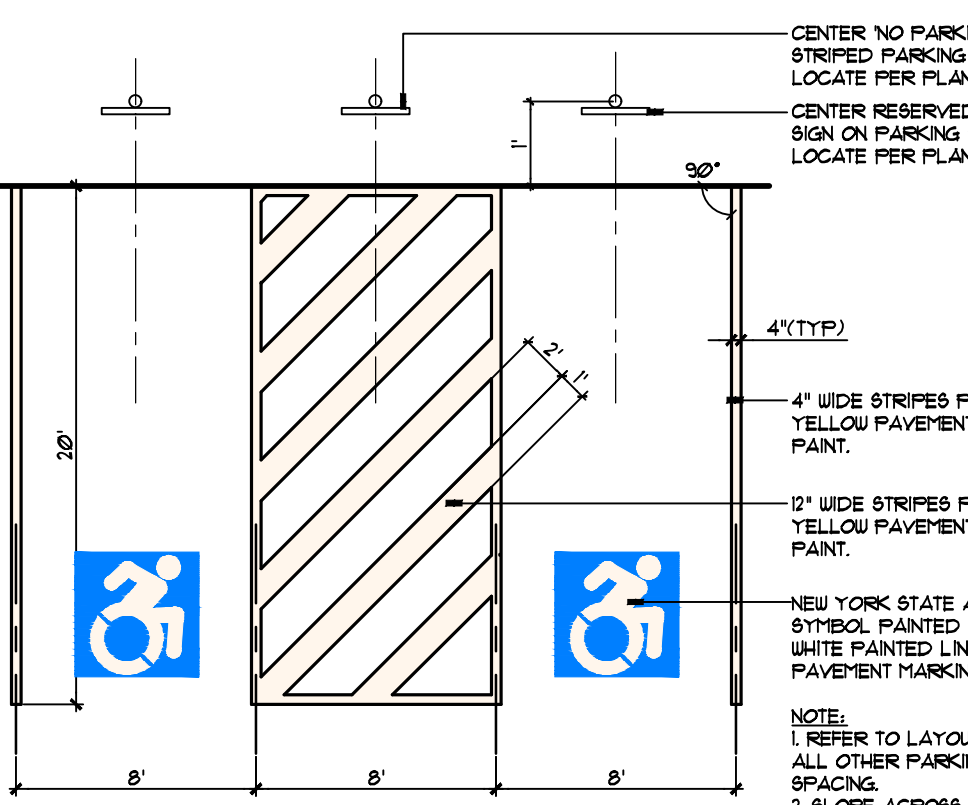

**11 RESERVED PARKING STALL**  
NOT TO SCALE 32-1723-01

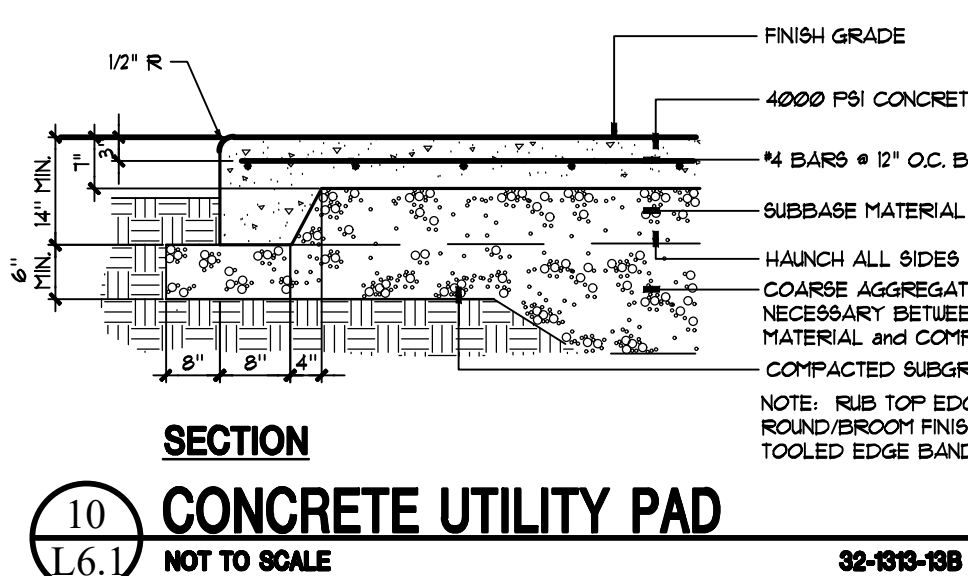

**10 CONCRETE UTILITY PAD**  
NOT TO SCALE 32-1313-138

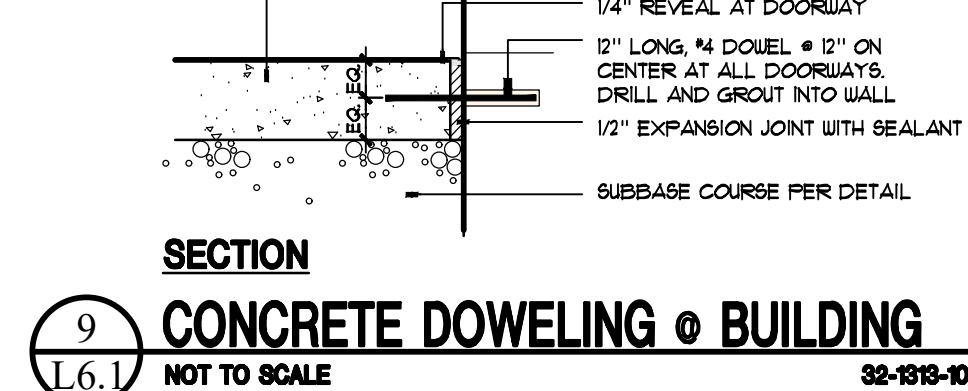

**9 CONCRETE DOWELING TO BUILDING**  
NOT TO SCALE 32-1313-10

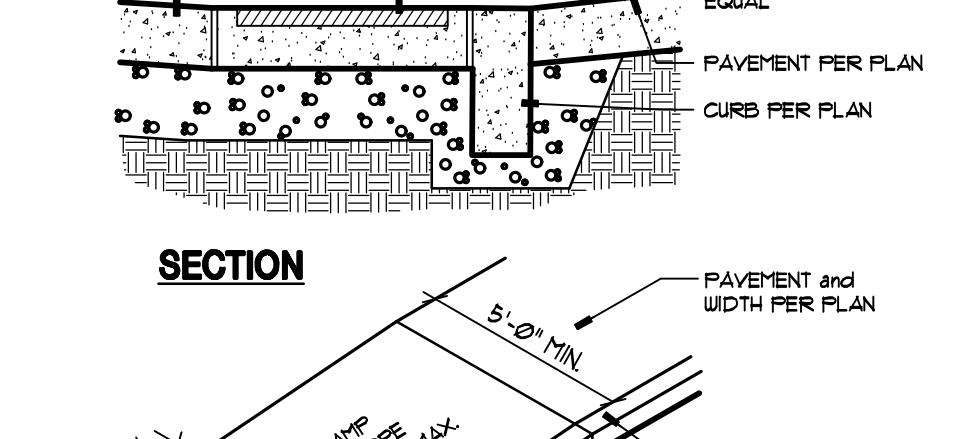

**8 ACCESSIBLE RAMP - TYPE 2**  
NOT TO SCALE 32-1313-093

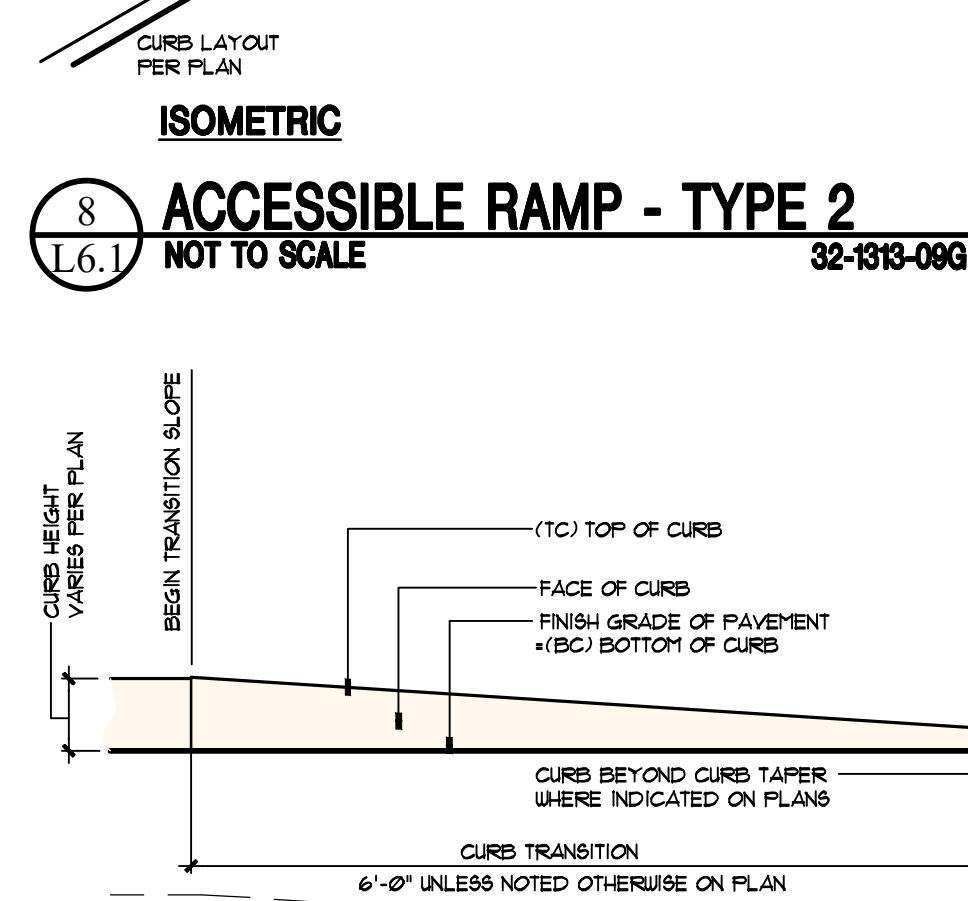

**7 CURB ENDING/TAPER (CE/CT)**  
NOT TO SCALE 32-1313-07

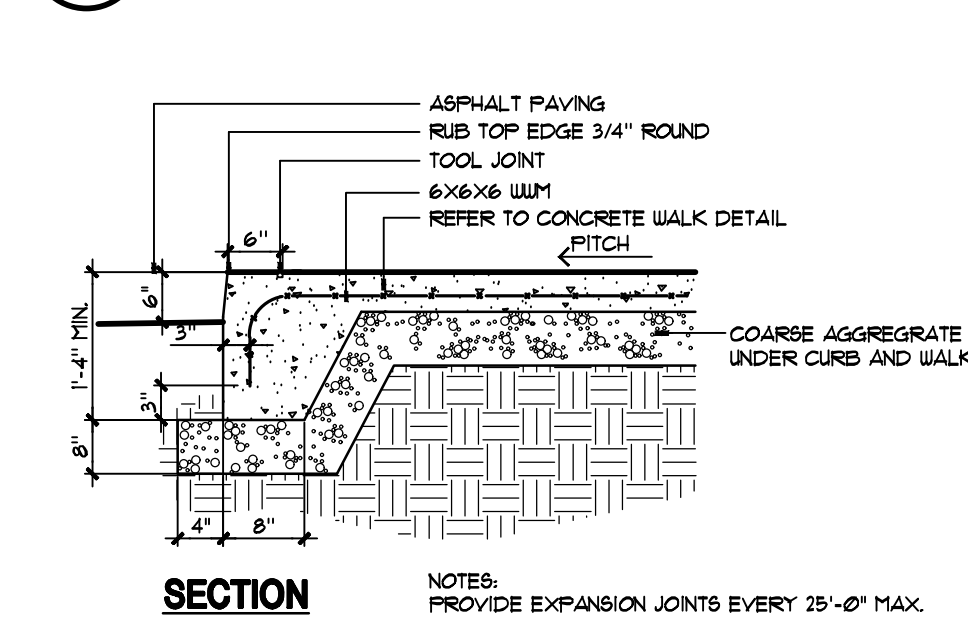

**6 CONCRETE CURB - INTEGRAL**  
NOT TO SCALE 32-1313-06

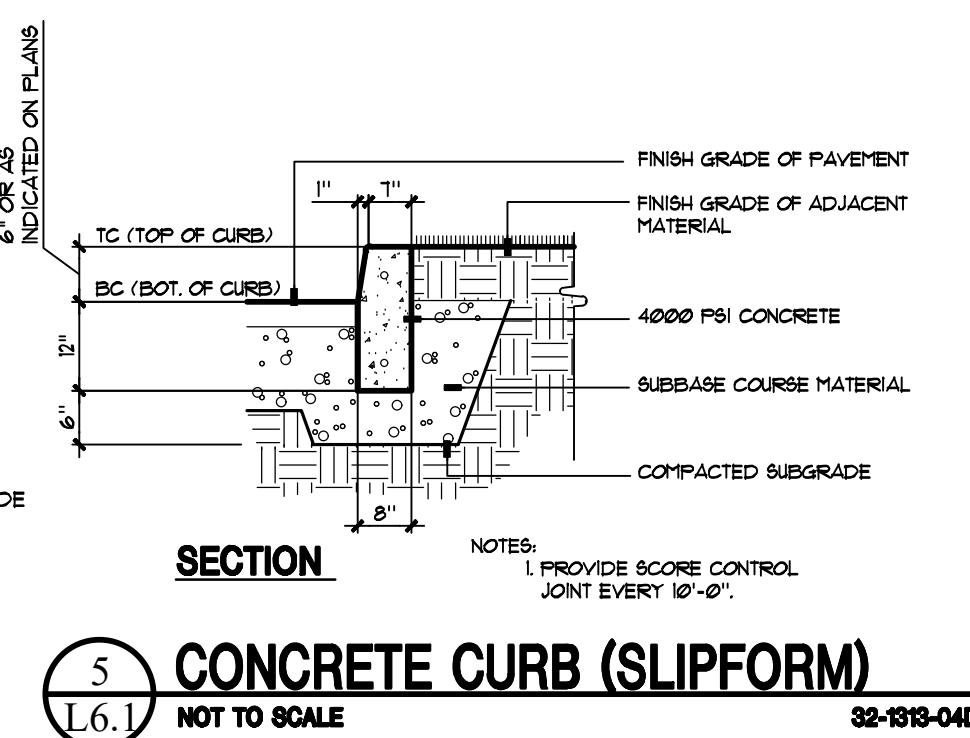

**5 CONCRETE CURB (SLIPFORM)**  
NOT TO SCALE 32-1313-040

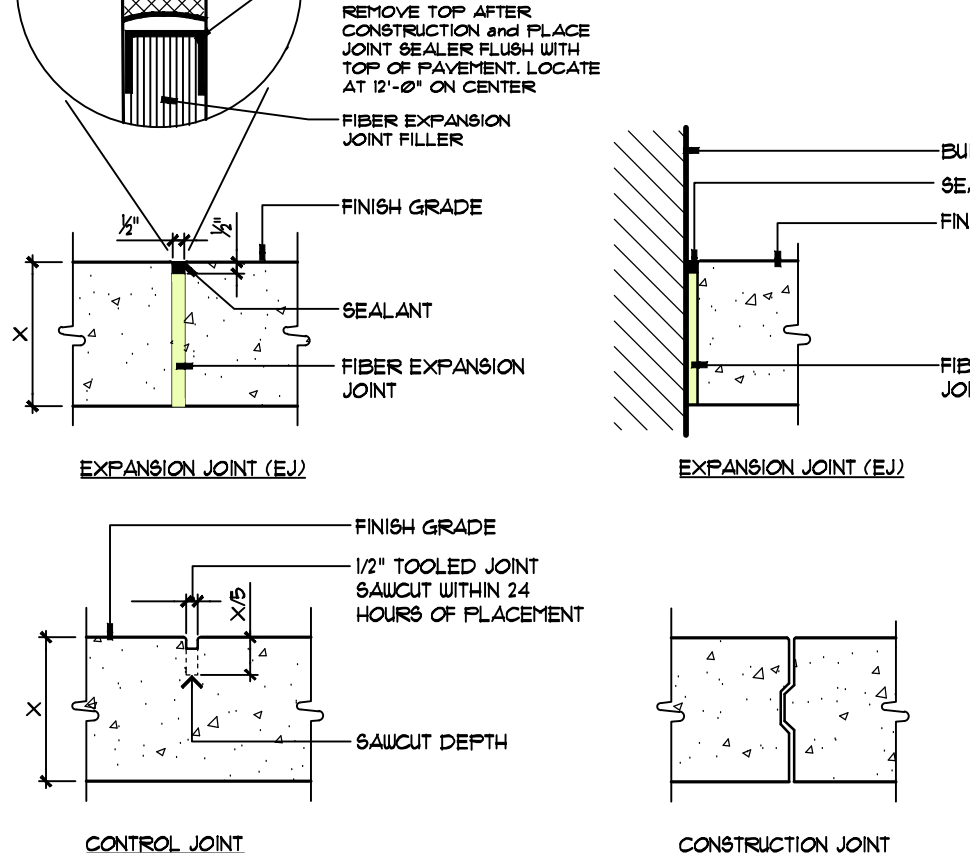

**4 CONCRETE JOINT DETAILS**  
NOT TO SCALE 32-1313-04

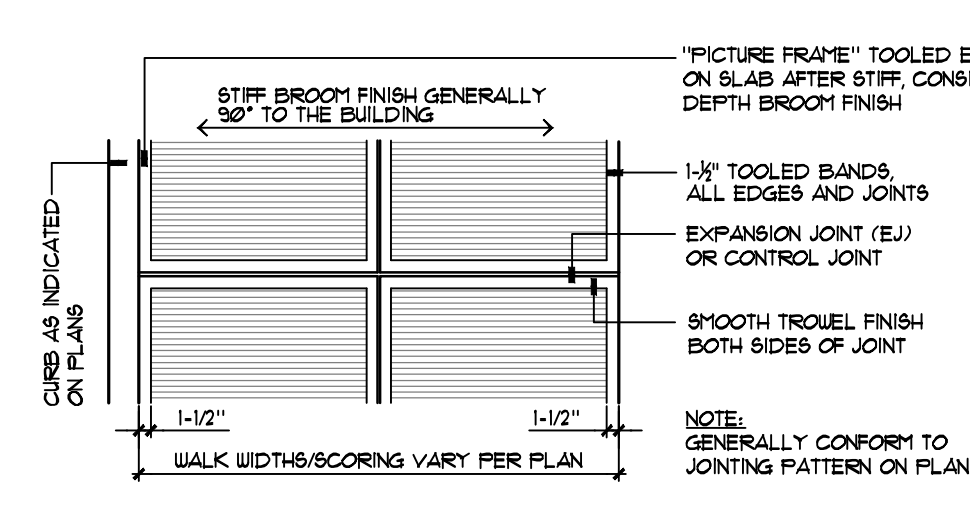

**3 CONCRETE FINISH**  
NOT TO SCALE 32-1313-03

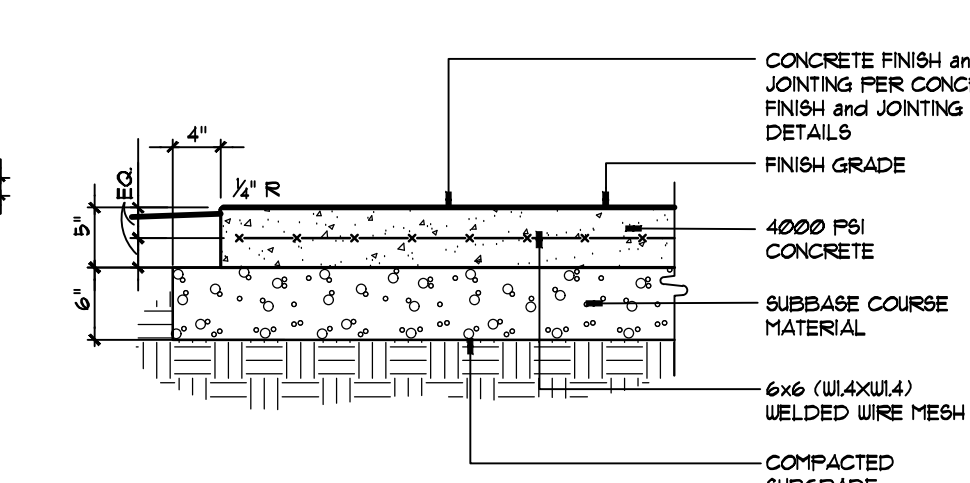

**2 CONCRETE PAVEMENT**  
NOT TO SCALE 32-1313-01

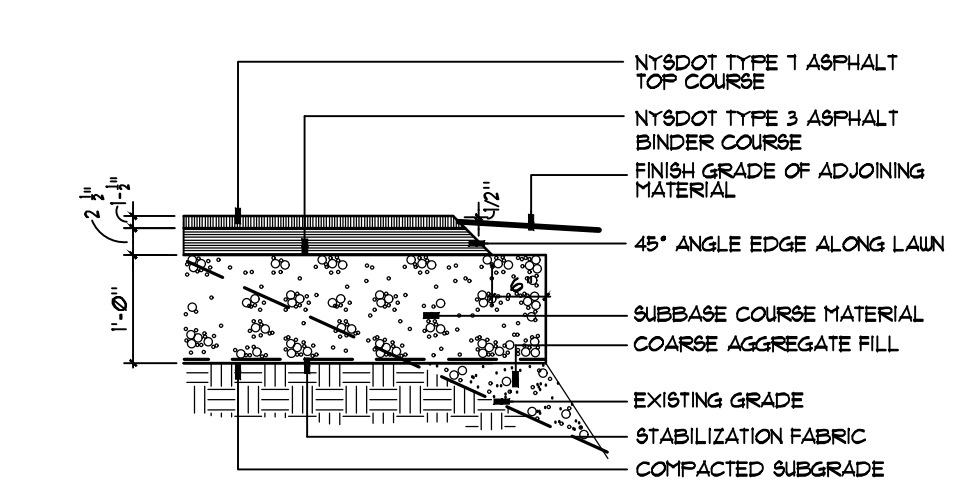

**1 ASPHALT PAVEMENT - PARKING**  
NOT TO SCALE 32-1313-02



**KEPLINGER FREEMAN ASSOCIATES**  
LANDSCAPE ARCHITECTURE & LAND PLANNING  
6320 FLY ROAD, SUITE 109, EAST SYRACUSE, NEW YORK 13057  
PHONE: (315) 445-7980 FAX: (315) 445-7981

**RZ Engineering, PLLC**  
315.432.1089



**ISSUED FOR PERMIT**

REV. NO.	DATE	DRAWN BY	DESCRIPTION

ALL DRAWINGS AND SPECIFICATIONS ARE THE PROPERTY OF THE ARCHITECT, AND SHALL BE USED ONLY ON THE JOB DESIGNATED. COPYRIGHT © THE CONTRACTOR SHALL VERIFY ALL DIMENSIONS AT THE SITE AND PROMPTLY NOTIFY THE ARCHITECT IN WRITING OF ANY DISCREPANCIES.

JOB NO: 22050  
SHARES NO: 20240329  
DATE: 07/18/25  
DRAWN BY: EK  
SCALE: SEE DRAWING

**RIVER STREET SENIOR HOUSING**  
30 RIVER STREET, CORTLAND, NEW YORK

**HOLMES • KING • KALLOUST & Associates, Architects, LLP**  
575 NORTH SALINA STREET, SYRACUSE, NY 13208  
PH: (315) 476-8371 FAX: (315) 476-5420  
www.hkkarchitects.com

**SITE DETAILS**

**L6.1**





NOTES:

1. PROVIDE A SILTATION SOCK FOR EVERY TWO FEET OF CHANGE IN VERTICAL ELEVATION.
2. INSTALL FILTREXX SILTOSXX, NORTH AMERICAN GREEN SEDIMAX SW- STARUL WATTLE OR APPROVED EQUAL PER MANUFACTURER'S SPECIFICATIONS.
3. FILL TO MEET APPLICATION REQUIREMENTS.
4. COMPOST MATERIAL TO BE DISPERSED ON SITE, AS DETERMINED BY ENGINEER.

13  
L6.2

**SILTATION**  
**NOT TO SCALE**



**PLAN**

**NOTES:**

1. INSTALL ON FLAT GRADE FOR OPTIMUM PERFORMANCE.
2. ALL CONCRETE WASHOUT FACILITIES SHALL BE REJECTED DAILY. DAMAGED OR LEAKING FACILITIES SHALL BE DECONTAMINATED OR REPAIRED OR REPLACED IMMEDIATELY. EXCESS RAINWATER SHALL BE ACCUMULATED OVER HARDENED CONCRETE SHOULD BE PUMPED INTO CONTAINMENT VESSEL.
3. ACCUMULATED HARDENED MATERIAL SHALL BE REMOVED WHEN 75% OF STORAGE CAPACITY OF THE STRUCTURE IS FILLED. ANY EXCESS WASHOUT WATER SHALL BE PUMPED INTO CONTAINMENT VESSEL, AND PROPERLY DISPOSED OF OFF-SITE.
4. DISPOSAL OF HARDENED MATERIAL OFF SITE IN A CONSTRUCTION/DEMOLITION FILL LANDFILL ON-SITE DISPOSAL MAY BE ALLOWED IF THIS HAS BEEN APPROVED AND ACCEPTED AS PART OF THE SUPPLY IN CASE, THE MATERIAL SHOULD BE RECYCLED AS SPECIFIED, OR BURIED AND COVERED WITH A MINIMUM OF 6" OF CLEAN CRUSHED SANDFILL THAT IS PERMANENTLY STABILIZED TO PREVENT EROSION.
5. THE PLASTIC LINER SHALL BE REPLACED WITH EACH CLEANING OF WASHOUT FACILITY.
6. PROTECT THE PROJECT SITE PROPERLY TO ENSURE THAT NO CONCRETE DISCHARGES ARE TAKING PLACE IN NON-DESIGNATED AREAS.

12  
L6.2



**ELEVATION**

9 HYDRA  
L6.2 N.T.S.



PLAN

THRUST BLOCK NOTES

1. FOR REQUIRED BEARING AREA DIMENSIONS A & B SEE TABLE. DIMENSIONS OF A & B OTHER THAN THOSE SHOWN IN THE TABLE MAY BE USED PROVIDED THEY YIELD A BEARING AREA EQUAL TO OR LARGER THAN THAT REQUIRED.
2. CONCRETE NOT TO OVERLAP AN JOINT.
3. CONCRETE TO BE PLACED SO AS NOT TO INTERFERE WITH REMOVING OR INSTALLING ANY OF THE JOINTING HARDWARE.
4. APPROXIMATE VOLUME OF CONCRETE THRUST BLOCK:  
$$V = \frac{LD \cdot (D + ID) \cdot ID}{8}$$
WHERE: V = VOLUME IN CUBIC YARDS  
L = LENGTH OF BLOCK IN FEET  
D = DEPTH OF BLOCK IN FEET  
W = WIDTH OF BLOCK IN FEET  
ID = INSIDE DIAMETER OF PIPE IN FEET
5. VALUES FOR TIE ALSO APPLY TO END PLUGS, CAPS, AND TAPPING SLEEVES.
6. REQUIRED BEARING AREA ARE DUE TO THURSTS CAUSED BY 80 PSI WORKING PRESSURE PLUS 80% (72 PSI) SURGE ALLOWANCE RESULTING IN 224 PSI TOTAL INTERNAL PRESSURE. NOMINAL PIPE DIAMETER USED.

1. REQUIRED BEARING AREAS ARE BASED ON ALLOWABLE SOIL BEARING CAPACITY OF 3000 LBS. PER SQUARE FOOT. IF POORER SOIL BEARING CONDITIONS ARE ENCOUNTERED, REQUIRED BEARING AREAS MAY BE MODIFIED BY THE ENGINEER.

2. IN MUCK, PEAT, OR RECENTLY PLACED FILL, ALL THRUST SHALL BE RESISTED BY PILES OR THE RODS TO SOLID FOUNDATIONS, OR BY REMOVAL OF SUCH UNSTABLE MATERIAL AND REPLACEMENT WITH BALLAST OF SUFFICIENT STABILITY TO RESIST THE THRUSTS, ALL AS REQUIRED BY THE ENGINEER.

## 8 THRUST BLOCK DETAILS

**THRUST**  
**NOT TO SCALE**



**7**  
**L6.2** **STONE**  
**NOT TO SCALE**



SECTION  
GATE V



PLAN

PAVED AREAS

PAVED AREAS

FINISH GRADE

FRAME AND GASKETED COVER COVER ELEVATION PER PLAN AND PROFILE. LETTERING ON COVER TO READ "MAN SEWER".

CONCRETE

BRICK COURSE (2 MIN. 4 MAX) FARGE INSIDE AND OUT

2'-0"



**SECTION**

**5** **SANITARI**  
**L6.2** **NOT TO SCALE**

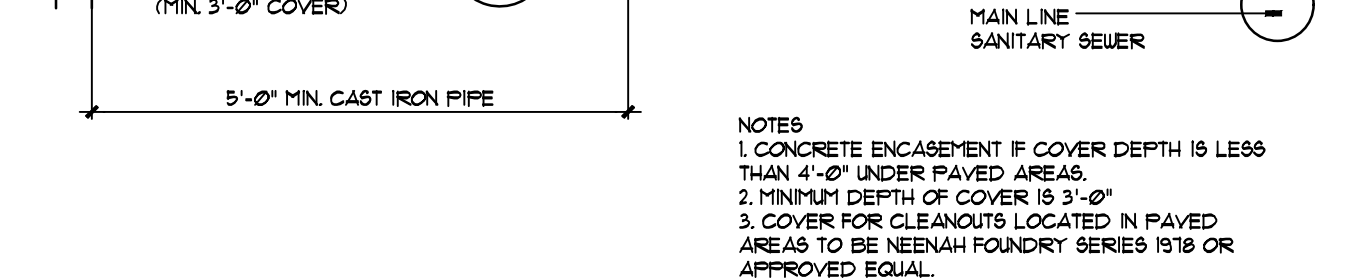

NOTES  
1. CONCRETE ENCASMENT IF COVER DEPTH IS LESS THAN 4'-0" UNDER PAVED AREAS.  
2. MINIMUM DEPTH OF COVER IS 3'-0"  
3. COVER FOR CLEANOUTS LOCATED IN PAVED AREAS TO BE NEENAH FOUNDRY SERIES 1918 OR APPROVED EQUAL.

4 (IN LAW  
162 NOT TO SCALE



**LATERAL CR**



**LONGITUDINAL SPILLWAYS**

3  
L6.2

**SPILLWAY**  
**NOT TO SCALE**



**SECTION**

NOTES:

1. TRENCH DEPTHS, WIDTHS, SHEETING, SHORING, BRACING and CUTBACK SLOPES to be DETERMINED by the CONTRACTOR and COMPLY with O.S.H.A., NEW YORK STATE DEPARTMENT OF LABOR NEW YORK STATE INDUSTRIAL CODE and ALL OTHER APPLICABLE SAFETY STANDARDS.
2. REFER to PLAN FOR PAVED and NON PAVED DETAILS.

2  
L6.2



**SECTION**  
**CLEANOUT (CO)**  
**NOT TO SCALE** **33-3913-25**

1  
L6.2

**CLEAN**  
**NOT TO SCALE**



6320 FLY ROAD SUITE 109  
EAST SYRACUSE, NY 13057  
PH: 315.432.1089

[illegible]

**HOLMES ■ KING ■ KALLQUIST**  
**& Associates, Architects, LLP**  
 575 NORTH SALINA STREET, SYRACUSE, NY 13208  
 PH: (315) 476- 8371 FAX: (315) 476- 5420  
[www.hkkarchitects.com](http://www.hkkarchitects.com)



## SITE DETAILS

# L6.2



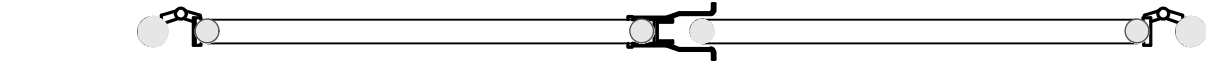

GATE PLAN

GATE FRAME SIZE SCHEDULE

NOM HEIGHT (H)	UPRIGHT HT (U) (ACTUAL DIM)	FRAME HT (F) (ACTUAL DIM)
4'-0"	3'-10"	3'-8 1/2"

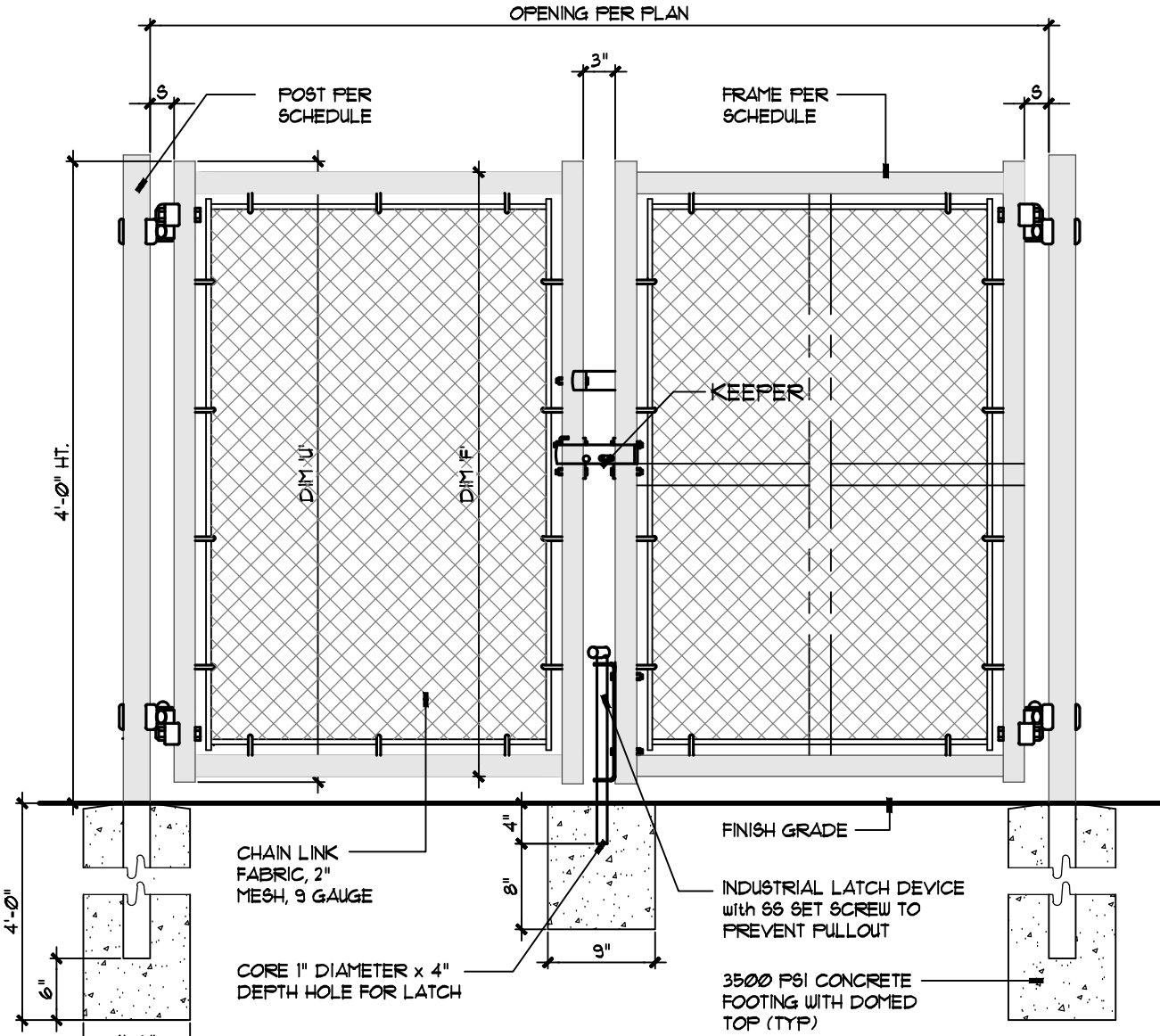

DOUBLE GATE ELEVATION

POST SIZE SCHEDULE

OPENING FACE TO FACE	GATE POSTS ROUND SIZES	HINGE SPACE (S) POST TO UPRIGHT
8'-0" THROUGH 12'-0"	2-8 1/2" OD	2 1/4"

NOTE:

- CENTER UPRIGHT REQUIRED ON GATE LEAVES 8'-0" & WIDER. CENTER RAIL REQUIRED ON GATE LEAVES 10'-0" & HIGHER.
- TOP OF FOOTING SHALL BE 2" BELOW FINISH GRADE IN LAWN AREAS.

DOUBLE LEAF  
CHAIN LINK SWING GATE

3  
L6.3

NOT TO SCALE

32-3118-03

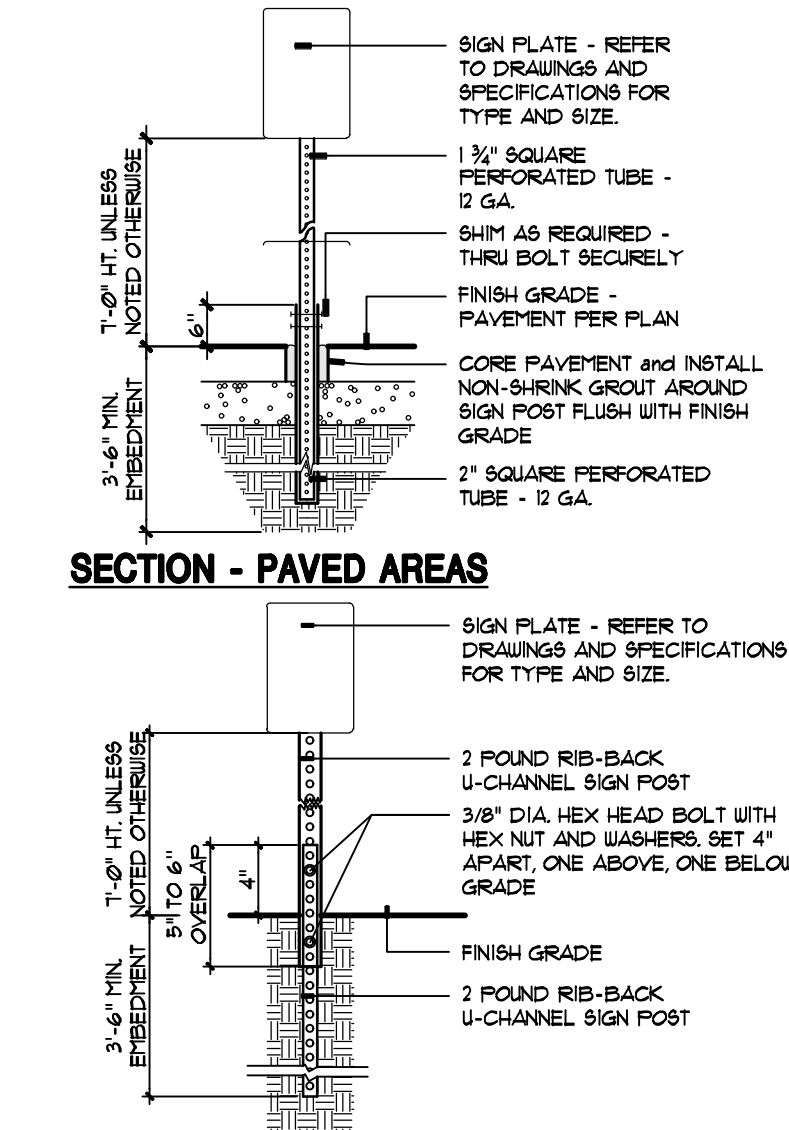

SECTION - PAVED AREAS

SECTION - NON-PAVED AREAS

- NOTES:
- FABRICATE SIGN PANELS OF 2000 ALUMINUM.
  - ALL SIGNS SHALL BE FASTENED TO OR MOUNTED ON POST WITH GALVANIZED BOLTS, NUTS AND WASHERS.
  - FOR FURTHER INFORMATION, REFER TO THE LATEST EDITION OF THE MANUAL OF UNIFORM TRAFFIC CONTROL DEVICES FOR STREETS AND HIGHWAYS, U.S. DEPARTMENT OF TRANSPORTATION, FEDERAL HIGHWAY ADMINISTRATION.
  - COORDINATE SIGN LOCATION TO AVOID UTILITIES.

TRAFFIC CONTROL SIGN

NOT TO SCALE

32-4000-01

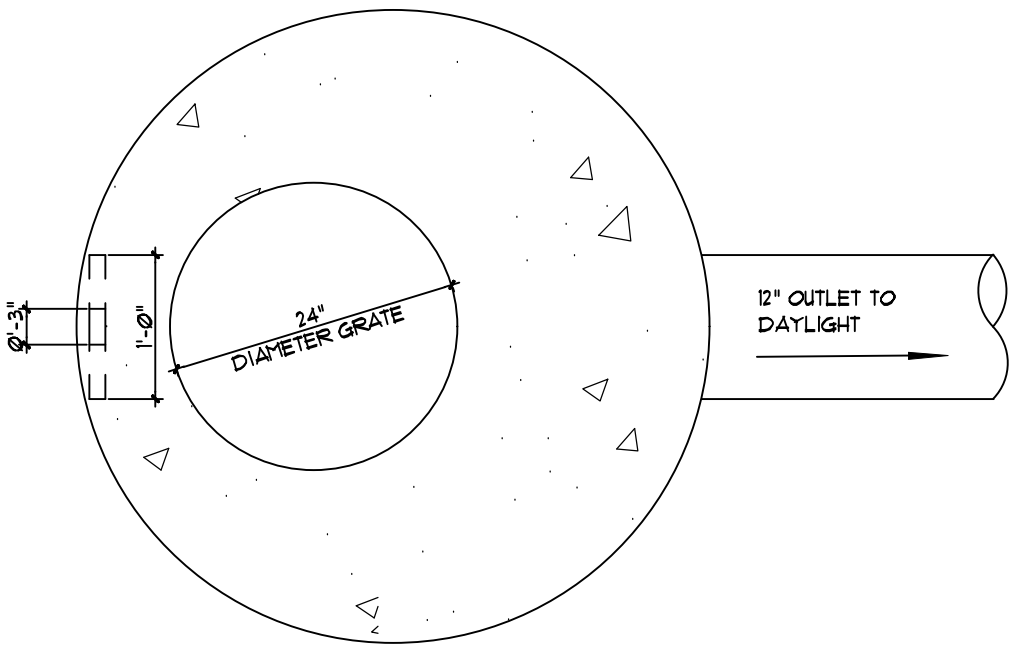

PLAN VIEW

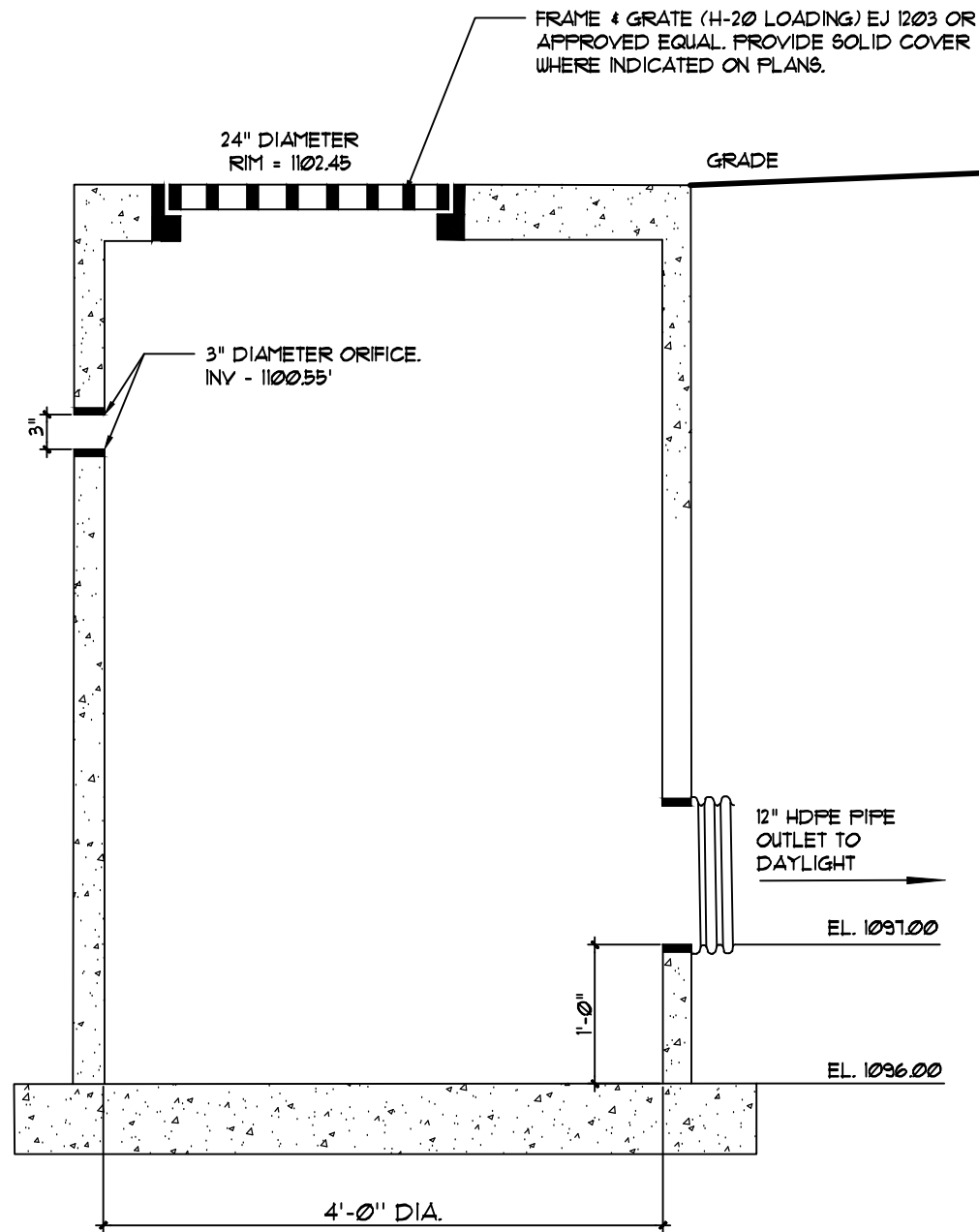

SECTION

NOTE: SECTION SHOWN FOR SCHEMATIC PURPOSES ONLY

OUTLET STRUCTURE (PRDA-1B)

NOT TO SCALE

1  
L6.3



LANDSCAPE ARCHITECTURE & LAND PLANNING  
6320 FLY ROAD, SUITE 109 EAST SYRACUSE, NEW YORK 13057  
PHONE: (315) 445-7980 FAX: (315) 445-7981

RZ Engineering, PLLC

6320 FLY ROAD SUITE 109  
EAST SYRACUSE, NY 13057  
PH: 315.432.1089



ISSUED FOR PERMIT

REV NO.	DATE	DRAWN BY	DESCRIPTION

ALL DRAWINGS AND SPECIFICATIONS ARE THE PROPERTY OF THE ARCHITECT, AND SHALL BE USED ONLY ON THE JOB DESIGNATED. COPYRIGHT ©

THE CONTRACTOR SHALL VERIFY ALL DIMENSIONS AT THE SITE AND PROMPTLY NOTIFY THE ARCHITECT IN WRITING OF ANY DISCREPANCIES.

JOB NO: 22050 SHARS NO. 20240329 DATE: 07/18/25 DRAWN BY: EK SCALE: SEE DRAWING
---

RIVER STREET SENIOR HOUSING

30 RIVER STREET, CORTLAND, NEW YORK

HOLMES • KING • KALLOQUIST  
& Associates, Architects, LLP  
575 NORTH SALINA STREET, SYRACUSE, NY 13208  
PH: (315) 476-8371 FAX: (315) 476-5420  
www.hkkarchitects.com

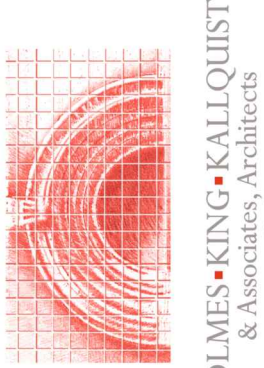





SITE DETAILS

L6.3



Calculation Summary							
Label	CalcType	Units	Avg	Max	Min	Avg/Min	Max/Min
AsphaltLOT Planar	Illuminance	Fc	2.32	10.1	0.0	N.A.	N.A.
PropertyLine	Illuminance	Fc	0.02	0.1	0.0	N.A.	N.A.
Walkway Planar	Illuminance	Fc	2.08	8.3	0.0	N.A.	N.A.

 0.2 - 0.29 fc  
 0.3 - 0.49 fc  
 0.5 - 0.99 fc  
 1.0 - 1.99 fc  
 2.0 - 5.0 fc

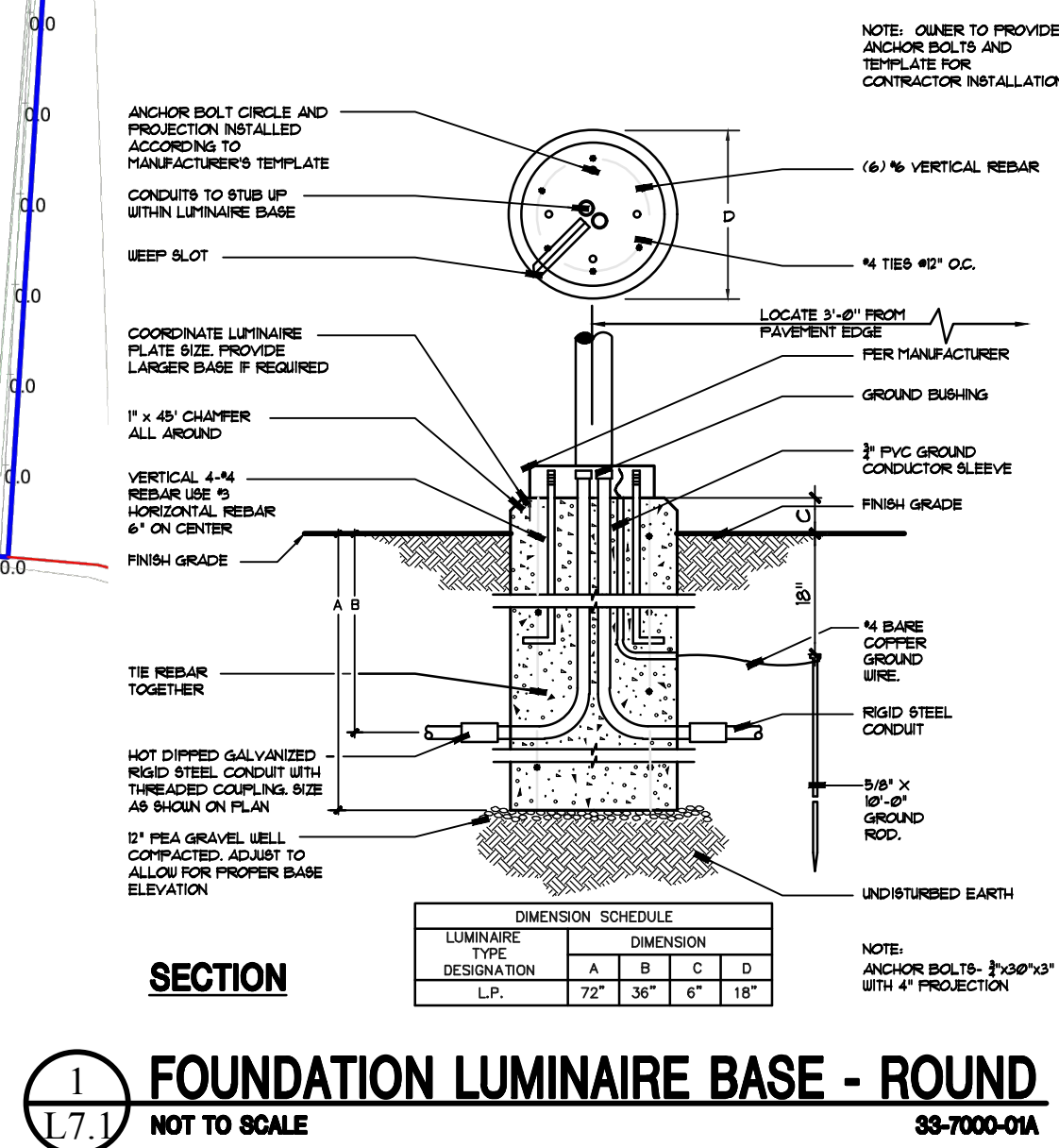
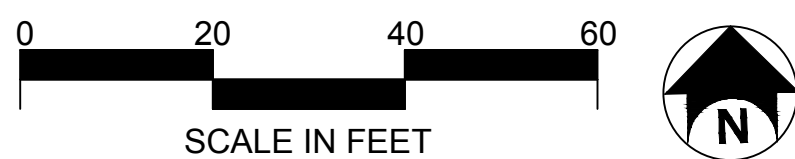

**FOUNDATION LUMINAIRE BASE - ROUND**  
NOT TO SCALE 33-7000-01A



Drawn By: M. Woznicki, LC  
Checked By:  
Date: 10/19/2022  
  
Scale:

Portland 2  
19.2022



**KFA** KEPLINGER  
FREEMAN  
ASSOCIATES  
LANDSCAPE ARCHITECTURE & LAND PLANNING  
6320 FLY ROAD, SUITE 109 EAST SYRACUSE, NEW YORK 13057  
PHONE: (315) 445-7980 FAX: (315) 445-7981

RZ Engineering, PLLC



ISSUED FOR PERMIT

ALL DRAWINGS AND SPECIFICATIONS ARE THE PROPERTY OF THE ARCHITECT, AND SHALL BE USED ONLY ON THE JOB DESIGNATED. COPYRIGHT ©
THE CONTRACTOR SHALL VERIFY ALL DIMENSIONS AT THE SITE AND PROMPTLY NOTIFY THE ARCHITECT IN WRITING OF ANY DISCREPANCIES.

	JOB NO: 22050
	SHARS NO: 20240329
	DATE: 07/18/25
	DRAWN BY: EK
	SCALE: SEE DRAWING

RIVER STREET SENIOR HOUSING

330 RIVER STREET, CORTLAND, NEW YORK

**HOLMES • KING • KALLQUIST**  
**& Associates, Architects, LLP**  
 575 NORTH SALINA STREET, SYRACUSE, NY 13208  
 PH: (315) 476-8371 FAX: (315) 476-5420  
[www.hkkarchitects.com](http://www.hkkarchitects.com)

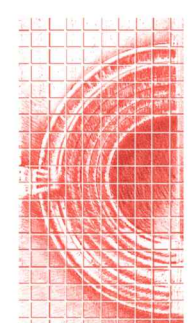

HOLMES • KING • KALLQUIST  
& Associates, Architects

www.3dmaxchina.com

PHOTOMETRIC  
PLAN

# L7.1